

CERTIFIED LAND CORNER RECORDATION

DESCRIPTION OF CORNER EVIDENCE FOUND, AND ORIGINAL RECORD (IF KNOWN)

ORIGINAL RECORD: 1873, GEO. W. IRVINE, SET A SANDSTONE, 12X10X7 IN., 7 INCHES IN THE GROUND FOR 1/4 SEC. CORNER, MARKED 1/4 ON THE N. SIDE. FLINT CREEK IS 4.20 CHAINS TO THE WEST, AN OLD WAGON ROAD IS 6.81 CHAINS TO THE EAST.

EVIDENCE FOUND: NO ORIGINAL EVIDENCE OF CORNER, CORNER POSITION FALLS WITHIN THE PRESENT LOCATION OF THE BLACK PINE COUNTY ROAD. OLD CREEK CHANNEL AGREES WITH MY DETERMINED POSITION. EXISTING FENCELINE TO THE EAST OF CORNER AGREES APPROXIMATELY WITH MY DETERMINED POSITION. SECTION LINE IS ESTABLISHED BY C.O.S.'S 156 AND 487 UP TO THE WESTERLY BOUNDARY OF C.O.S. 487 WHICH I ACCEPT.

DESCRIPTION OF MONUMENT AND ACCESSORIES ESTABLISHED TO PERPETUATE THE ORIGINAL LOCATION OF THIS CORNER:

DATE OF WORK 5/28/99

USING RECORD BEARING DETERMINED BY SOLAR OBSERVATION AND RECORD DISTANCE FROM THE SECTION CORNER COMMON TO SECTIONS 11,12,13,14 I SET A 5/8 REBAR W/ ALUM. CAP .5 FT. BELOW THE EXISTING ROAD SURFACE. ERECTED YELLOW SIGN ON FENCEPOST NEARBY.

NOTE: I DID NOT SET THIS CORNER USING THE SINGLE PROPORTION METHOD BECAUSE OF EVIDENCE OBTAINED FROM THE SOLAR OBSERVATION, EXISTING FENCELINE, OLD CREEK CHANNEL, C.O.S. 156, C.O.S. 487..

SKETCH, WITH COURSE AND DISTANCE TO ADJACENT CORNERS IF DETERMINED IN THIS SURVEY,

SEE C.O.S. 53-M

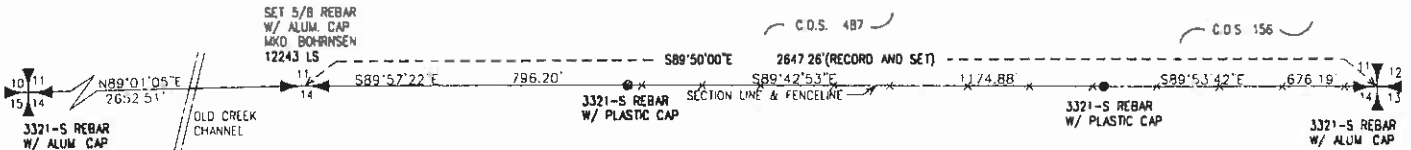

not to scale

SURVEYOR'S SEAL

DIAGRAM OF CORNER

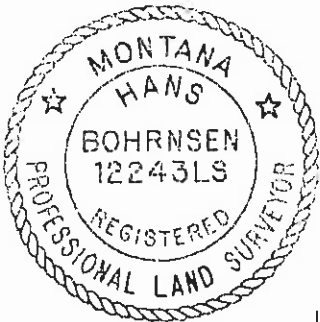

I, HANS BOHRNSEN, Certify that the information shown herein is true and correct.

Hans BohrnSEN
HANS BOHRNSEN 12243 LS

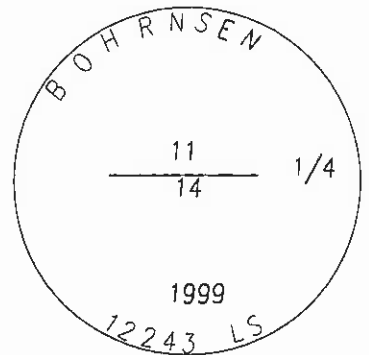

SET REBAR WITH ALUMINUM CAP AS SHOWN ABOVE

Office of Clerk and Recorder, County of Granite

This "corner record" was filed for record on the 8th day of June, ~~19~~ 2000 was noted on the cross index plot and is assigned page No. _____, in book No. _____

Go Bayer
Signature of County Official

41107

● CORNER THIS SHEET

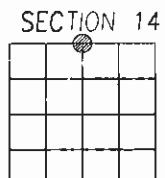

Cross Index No. J 19 sec. 11/14 T. 7N R. 14W