

255238

INSTRUCTIONS

1. Original and/or subsequent record used to evaluate the corner position.
2. Description of evidence found, note discrepancies in the record, state method of establishing lost or obliterated corners.
3. Description of monument and accessories set to perpetuate the corner position.
4. Sketch of corner, show all pertinent data which can best be shown in a sketch example, corner marking, topography ties, position of accessories, etc.
5. Certification must be signed and sealed by Land Surveyor registered in the State of Montana.
6. Fill in Cross Index & Section Diagram at bottom of sheet.

CERTIFIED CORNER RECORDATION

Corner EAST 1/4 SECTION 34 T. 7N R. 25E P.M.M. MUSSELSHELL County

1. SET A SANDSTONE 14X13X7" INS. 9 INS. IN THE GROUND FOR 1/4 SECTION CORNER MARKED 1/4 ON WEST FACE. AND RAISED A MOUND OF STONES ALONGSIDE. PITS INPRACTIBLE.
2. FOUND A MARKED SET SAND STONE OF RECORD SIZE.
3. SET A 5/8 X 30" REBAR WITH A 2" ALUMINUM CAP FIRMLY AFFIXED NEXT TO THE SAND STONE MARKED AS SHOWH BELOW. NOTE: THE GROUND WAS FROZEN SO I COULD NOT REMOVE THE STONE AND REPLACE IT WITH THE REBAR AND CAP.

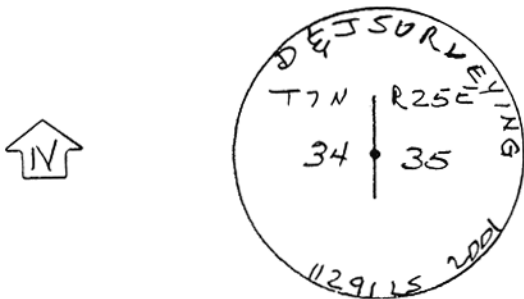
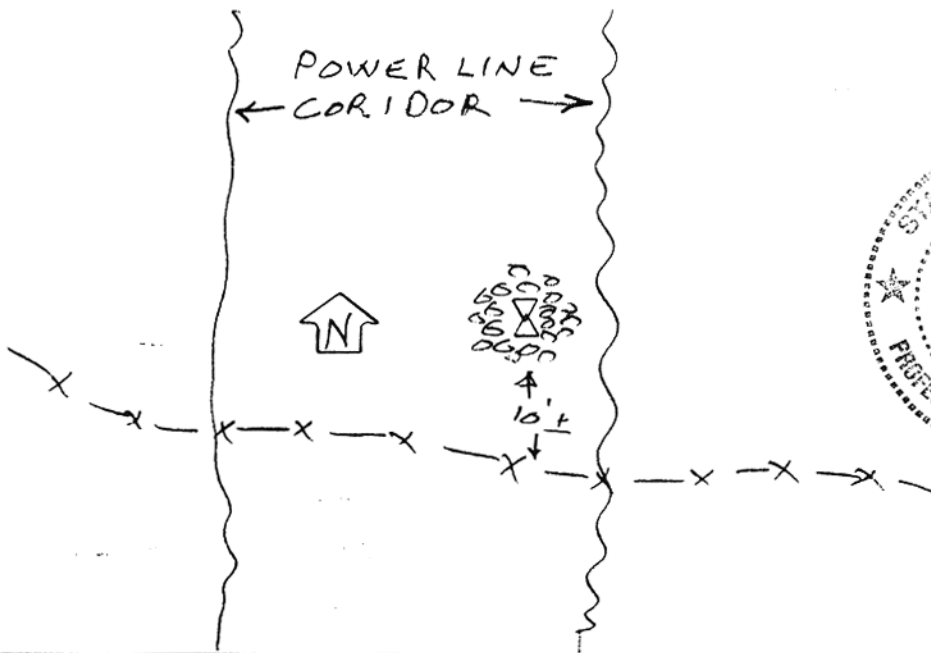

SKETCH OF CORNER

CERTIFICATION  
 I, JAMES F. SLEHOFER  
 certify the Information shown herein is true and correct.

Signature Ground Party Chief  
 I, JAMES F. SLEHOFER  
 certify that this Corner Record correctly represents work performed by me or under my direction in compliance with the "Corner Recordation Act" (70-22-101, et seq., M.C.A.)

James F. Slehofer  
 Signature of Surveyor & Seal  
 Date: 1/2001 Reg. No. 11291 LS  
 Employer: D. & J. SURVEYING

Office of Clerk and Recorder, County of MUSSELSHELL. This "corner record" was filed f 255238 Fee \$ .00  
MUSSELSHELL COUNTY  
 was noted on the cl Recorded 01/23/2002 At 12:56 PM  
 book No. Jane E Mang, Clerk and Recorder - , in  
 By Judith B Hawkins Deputy  
 County Official

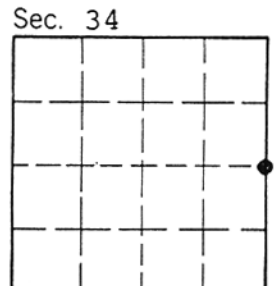

Cross Index No. X-17 T. 7 R. 25 PMM

• corner this sheet