

INSTRUCTIONS

1. Original and/or subsequent record used to evaluate the corner position.
2. Description of evidence found, note discrepancies in the record, state method of establishing lost or obliterated corners.
3. Description of monument and accessories set to perpetuate the corner position.
4. Sketch of corner, show all pertinent data which can best be shown in a sketch example, corner marking, topography ties, position of accessories, etc.
5. Certification must be signed and sealed by Land Surveyor registered in the State of Montana.
6. Fill in Cross Index & Section Diagram at bottom of sheet.

CERTIFIED CORNER RECORDATION

Corner Sections 8, 9, 16 & 19 T. 7 N. R. 59 E. P.M.M. Fallon County

**ORIGINAL RECORD:** (1909 G.L.O.) Set a sandstone 18x14x10 ins., 12 ins. in the ground for cor. to secs. 8, 9, 16 and 17 marked with 4 notches on the South and 4 notches on the East edge; and a raise mound of stone, 2 ft. high base 1 1/2 ft. high West of cor. Pits impracticable.

**SUBSEQUENT RECORD:** (1983 C.R. - Charles M. Madler) Re-established Section Corner position using Highway plans dated 2-18-37. Set 5/8"x24" rebar with aluminum cap.

**SUBSEQUENT RECORD:** (1988 C.R. - Jimmie Brewer) Found reference rebar and reference monument to section corner which is recorded in Book 1 Page 67 of the corner record book. Set 5/8"x18" rebar with 2" aluminum cap at true section corner position.

**SUBSEQUENT RECORD:** None found.

**EVIDENCE FOUND:** Found a 3-1/4" aluminum cap, in mound of stone, mid way in grassy R/W strip. 18.7 ft. to North is aluminum witness post.

**PERPETUATION:** Established a latitude and longitude for search purposes.  
Date of Survey: June, 2008.



VIEW LOOKING NORTH

NAD 83 coordinates for this corner:  
Latitude = 46°22'05.35747"N Longitude = 104°20'39.56730"W  
NOTE: These coordinates are to be used as a search tool only.

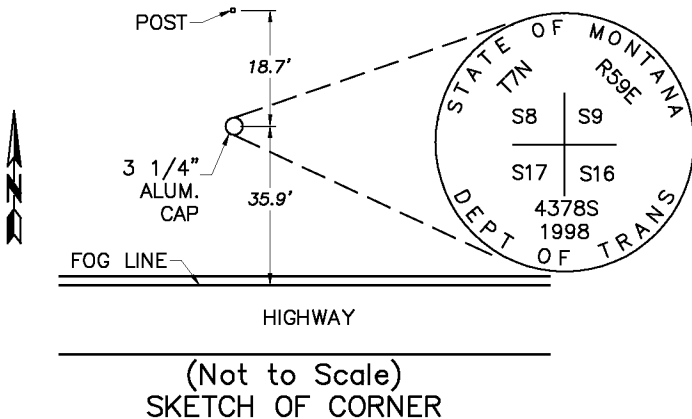

CERTIFICATION

I, Steve Cummings  
certify the information shown herein is true and correct.

\_\_\_\_\_  
Signature Ground Party Chief

I, Kurt A. Luebke  
certify that this Corner Record correctly represents work performed by me or under my direction in compliance with the "Corner Recordation Act" (70-22-101, et seq., M.C.A.)

\_\_\_\_\_  
Signature of Surveyor & Seal

Date: 7-6-2008 Reg. No. 13237 S

Employer: DJ&A P. C.

Office of Clerk and Recorder, County of Fallon. This "corner record" was filed for record on \_\_\_\_\_ was noted on the cross index plat and is assigned page No. \_\_\_\_\_, in book No. \_\_\_\_\_

\_\_\_\_\_  
County Official

Sec. 8

● - corner this sheet

Cross Index No. J-9 T. 7 N. R. 59 E. PMM