

CERTIFIED CORNER RECORDATION

Corner W 1/4 COR. S.21 T. 8N. R. 15E. P.M.M. Wheatland County

ORIGINAL RECORD: 1874 GLO NOTES: SET SANDSTONE 15 X 8 X 7 INS. 10 INS. IN THE GROUND FOR 1/4 SEC. COR. MARKED 1/4 ON W. FACE.

SUBSEQUENT RECORD:

EVIDENCE FOUND: FOUND A PARTIALLY SET LEANING SANDSTONE 20X9X9 IN. MARKED 1/4 ON WEST FACE.

RE-ESTABLISHMENT: MEASUREMENTS TO CORNERS N & S VERIFY THIS POSITION

PERPETUATION: SET STANDARD MDT 2"x30" ALUMINUM MONUMENT WITH 3.25" CAP AT DISPLACED STONE, 0.1' ABOVE GROUND. LAID ORIGINAL STONE ALONGSIDE. SET REFERENCE POST 0.5' SOUTH. SET REFERENCE MONUMENTS FLUSH WITH THE GROUND AS SHOWN BELOW.

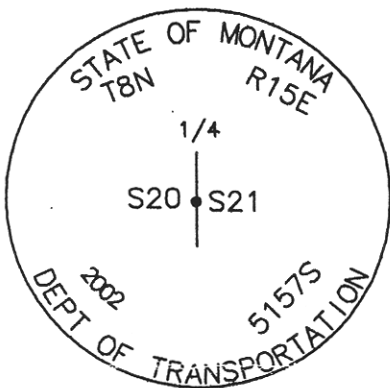
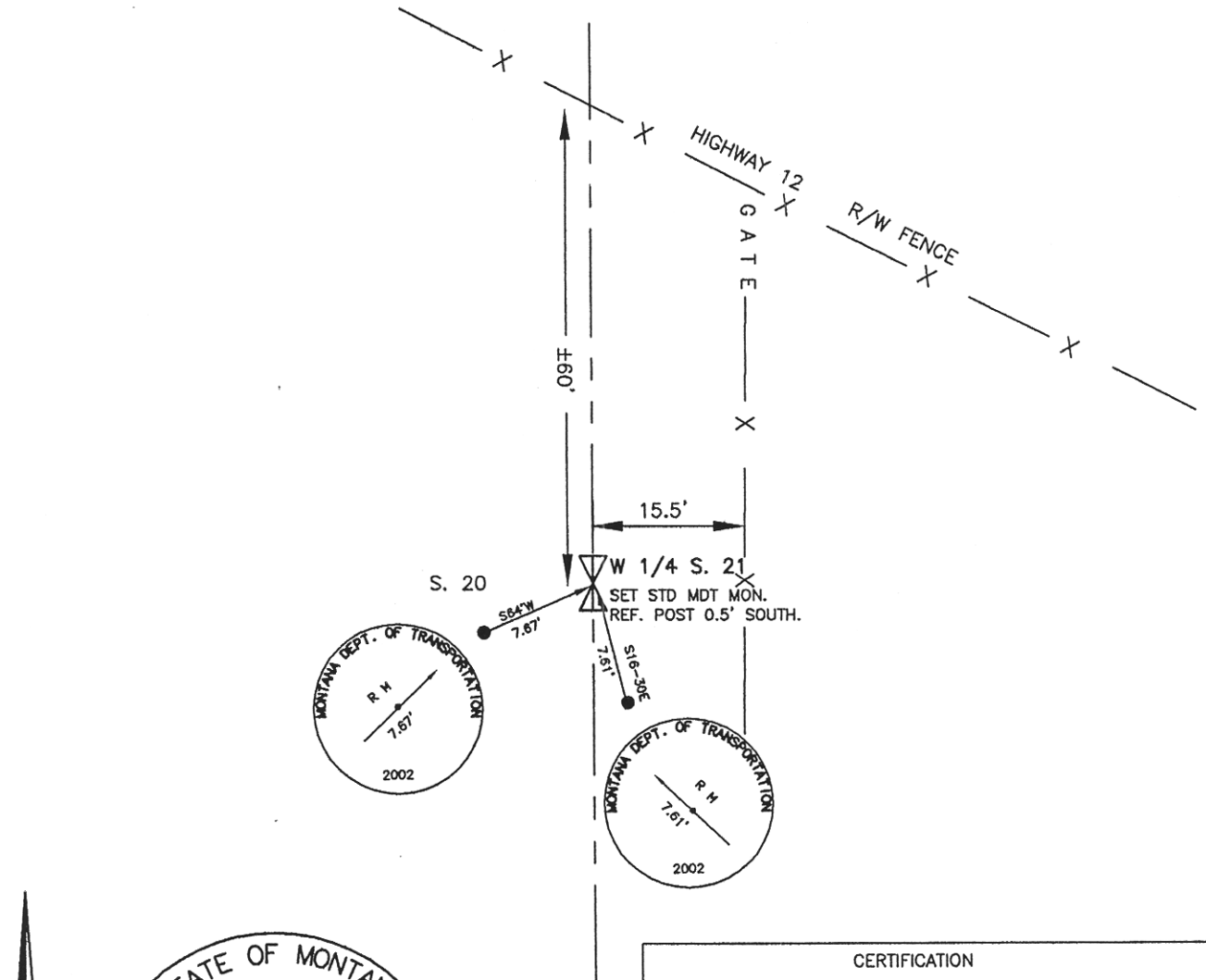

CERTIFICATION	
I, <u>PHIL KOTERBA</u>	
certify the information shown herein is true and correct	
<i>Phil Koterba</i>	Signature Ground Party Chief
I, <u>Daniel W. McGee</u>	
certify that this Corner Record correctly represents work performed by me or under my direction in compliance with the "Corner Recordation Act" (70-22-101, et seq., M.C.A.)	
<i>Daniel W. McGee</i>	Signature of Surveyor & Seal
Date: <u>12/29/02</u>	Reg. No. <u>5157S</u>
Employer: <u>HARP Engineering</u>	

Office of Clerk and Recorder, County of Wheatland. This "corner record" was filed for record on 12-23-02

was noted on the cross-index plat and is assigned page No. 174, in

~~document~~ book No. 101676

tsmart
County Official

Cross Index No. P 9 T. 8N. R. 15E. PMM

Sec. 21

● - Corner this sheet