

CERTIFIED LAND CORNER RECORDATION

DESCRIPTION OF CORNER EVIDENCE FOUND, AND ORIGINAL RECORD (IF KNOWN)

ORIGINAL RECORD:
No original record.

FOUND:
No original evidence remaining. Railroad plat and Roundup Park Addition used to re-establish corner.

DESCRIPTION OF MONUMENT AND ACCESSORIES ESTABLISHED TO PERPETUATE THE ORIGINAL LOCATION OF THIS CORNER:

Set a 24 ins. brass cap 20 ins. in the ground with brass cap marked:

Date of work: July 14, 1977

Corner located at South edge of County Road. Set 1" iron pipe 5 ft. tall set 3 ft. in the ground, 1' south of brass cap.

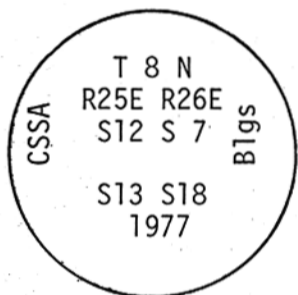
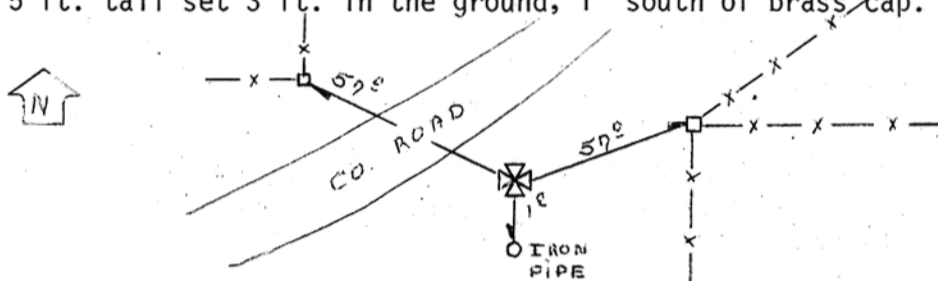

SKETCH, WITH COURSE AND DISTANCE TO ADJACENT CORNERS IF DETERMINED IN THIS SURVEY. (MAY SKETCH OR PASTE REPRODUCTION ON REVERSE SIDE.)

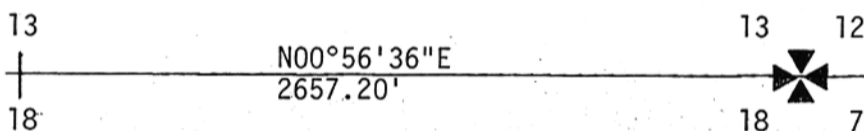

Surveyor's Seal

I, _____ certify that the information shown herein is true and correct.

Lawrence O. Talbot
Signature of Ground Party Chief

I, Fred A. Sielbach, Jr. certify that I have carefully performed or reviewed the work done on the diagrammed corner as reported on this recordation form and approve the same.

Fred A. Sielbach, Jr.
Signature of Surveyor

DIAGRAM OF CORNER:

N.

T 8 N
R25E R26E

S12 | S 7
S13 | S18

Musselshell County, M

= Corner recorded on the sheet

786-ES
Registration Number

Office of Clerk and Recorder, County of *Musselshell*

This "corner record" was filed for record on the *27th* day of *January*, 1978, was noted on the cross-index plat and is at *8:40 AM*

assigned page No. _____, in book No. _____

Frances L. Dawson
County Official

Cross Index No. *13* T. *8* R. *25* Mer.

rec'd 1.00