

# CERTIFIED CORNER RECORDATION

Corner: SE corner Section 34 T. 14N R. 18E P.M.M. Fergus County

Original Record: (Aug. 1886) 80.00 ch Set a sand stone 20x10x4 ins. 14 ins. in the ground, for cor. to secs.2,3,34 and 35, marked with 4 notches on W. and 2 notches on E. face, and raise a mound of stone alongside.

Subsequent Record: None

Evidence Found: Found original sandstone, 19"x10"x4", 2 vertical notches on east and 4 faint notches on the west, firmly set, with a scattered mound east of corner.

Perpetuation: Stone is well set, I refurbish the mound of stone and set MARLS tag as shown below.

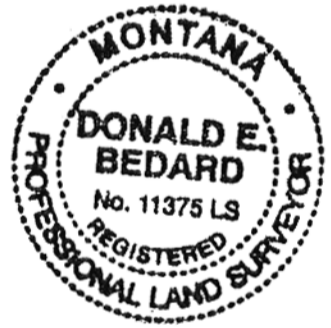
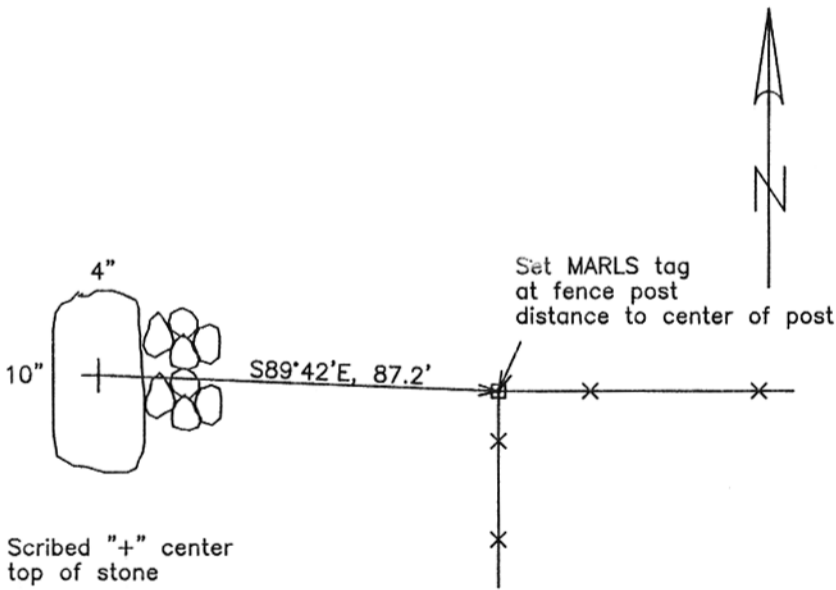

CERTIFICATION

I, Donald E. Bedard  
certify the information shown is true and correct.  
*Donald E. Bedard*  
Signature Ground Party Chief

I, Donald E. Bedard  
certify that this Corner Record correctly represents work performed by me or under my direction in compliance with the "Corner Recordation Act" (70-22-101, et seq., M.C.A.)  
*Donald E. Bedard*  
Signature of Surveyor & Seal

Date: \_\_\_\_\_ Reg. No. 11,375 LS

Employer: Beartooth Land Surveying

SP-4 SKETCH OF CORNER

Office of Clerk and Recorder, County of FERGUS. This "corner record" was filed for record on JAN 10 2002 was noted on the cross-index plat and assigned page No. 97, in book No. 6

*Kathy A. Fleck*  
 County Official

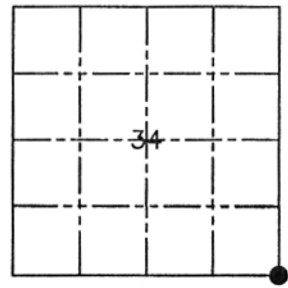

63501

Cross Index No. 2-17 T. 14N R. 18E PMM

● Corner this sheet