

CERTIFIED CORNER RECORDATION

Corner SOUTH 1/4 SECTION 17 T. 16N R. 12E P.M.M. JUDITH BASIN County

ORIGINAL RECORD: (Parsons 1882) Set sandstone 12 x 8 x 4 ins. 8 ins. in the ground for 1/4 sec. cor. marked 1/4 on N. face. dug pits 18 x 18 x 12 ins E & W of stone 5 1/2 ft. dist. and raised a mound of earth 1 1/2 ft. high 3 1/2 ft. base along side

SUBSEQUENT RECORD: (1985) C/S 100 by Ries - Shows found fence corner and stone at corner position with tie to set Center 1/4 corner of Section 17

EVIDENCE FOUND: (July, 2001) No monument was found at the fence corner. After conversations with Mr. Ries, it appears that he intended to use the same fence corner that was found by our crews. Even though there is a 33 foot distance difference between his and our measurement to the Center 1/4 of Section 17. The fence corner has been in place for more than 20 years.

PERPETUATION: At the base of the fence corner post, set a 5/8" rebar with 2" aluminum cap marked as shown below for the South 1/4 corner to Section 17. See drawing below.

SEE ASSOCIATED CERTIFICATE OF SURVEY

165043 Fee: \$ #5147
 JUDITH BASIN COUNTY Filed 01/28/2002 At 10:30 AM
 Amanda H. Kelly, Clk & Recd By Corinne VanKampen,
Deputy

T. 16N. R. 12E.

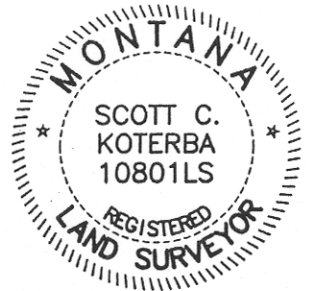
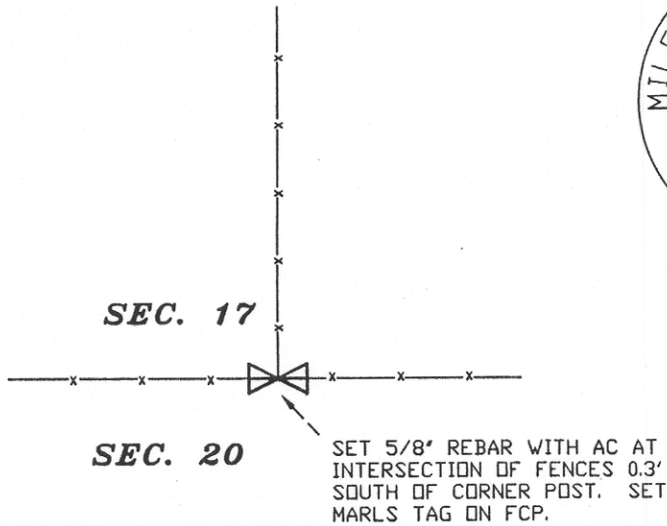

PN: 01-387

CERTIFICATION	
I, _____	certify the information shown herein is true and correct.
_____ Signature Ground Party Chief	
I, <u>Scott C. Koterba</u>	
certify that this Corner Record correctly represents work performed by me or under my direction in compliance with the "Corner Recordation Act" (70-22-101, et seq., M.C.A.)	
<u>Scott C. Koterba</u> Signature of Surveyor & Seal	
Date: <u>1/28/02</u>	Reg. No. <u>10801 LS</u>
Employer: _____	Milestone Surveying

SKETCH OF CORNER

Office of Clerk and Recorder, County of Judith Basin. This 'corner record' was filed for record on January 28, 2002 @ 10:30am was noted on the cross-index plat and is assigned page No. 5147, in book No. _____

County Official

Cross Index No. N-7 T. 16N R. 12E P.M.M.

Sec. 17

• corner this sheet