

53906

INSTRUCTIONS

1. Original and/or subsequent record used to evaluate the corner position.
2. Description of evidence found, note discrepancies in the record, state method of establishing lost or obliterated corners.
3. Description of monument and accessories set to perpetuate the corner position.
4. Sketch or corner, show all pertinent data which can best be shown in a sketch example, corner marking, topography ties, position of accessories, etc.
5. Certification must be signed and sealed by Registered Land Surveyor in State of Montana.
6. Fill in Cross Index & Section Diagram at bottom of sheet.

CERTIFIED CORNER RECORDATION

Corner #96 NW Corner Section 35 T. 16 N R. 12 E P.M.M. Judith Basin County

RECORD: 80 chains "set sand stone 14 x 12 x 8 ins. 10 ins. in the ground for Cor. to secs. 26. 27. 34. & 35. marked 1 notch on S. and 2 notches on E. edges. and raised a mound of stone alongside. Pits impracticable."

FOUND: No evidence of original corner or accessories

METHOD: At the intersection of fence alignments North, South, East and West (all distant from intersection point), I find evidence of an old road which obliterated all evidence of corner. I accept the position of the fence alignments for this section corner. Corner falls in open pasture. I place a steel survey marker post alongside.

SET: A 3/4 inch diameter aluminum cap riveted to a 30 inch flared aluminum tube 2 1/2 inches in diameter and marked as shown. (Cap is 6" out of the ground)

ACCESSORIES: The 1/4 corners to the West and South are as follows: S. 89° 18' 21" W., - 2,632.09 feet S. 00° 58' 26" E., - 2,720.40 feet.

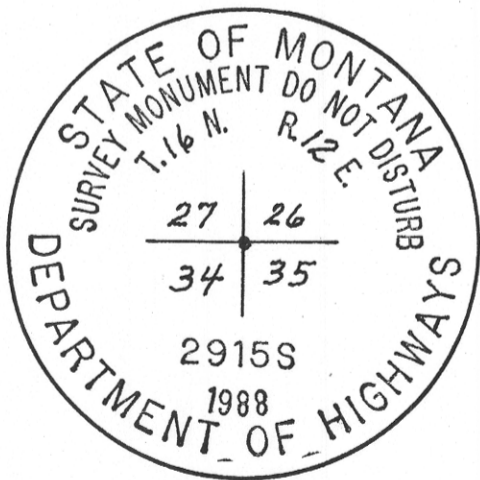

SKETCH OF CORNER

CERTIFICATION

I, \_\_\_\_\_ certify the information shown herein is true and correct.

Signature Ground Party Chief

I, Gerald S. Ditto certify that this Corner Record correctly represents work performed by me or under by direction in compliance with the "Corner Recordation Act" (70-22-101, et seq., M.D.A.)

Gerald S. Ditto  
Signature of Surveyor & Seal

Date: 2-23-89 Reg. No. 2915 S

Employer: Self

Office of Clerk and Recorder, County of Judith Basin. This "corner record" was filed for record on the November 20 day of 1989, was noted on the cross-index plat and is assigned page No. \_\_\_\_\_, in book No. File No. 459

Gerald S. Ditto  
County Official

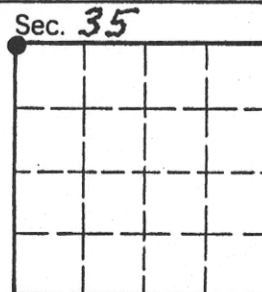

Cross Index No. V-17 T. 16 N R. 12 E P.M.M.

• - corner this sheet