

PLSS CORNER RECORD

Corner: 1/4 S30/31 T. 16 N., R. 12 W. P.M.M. Powell County

Original GLO Record: Lee Williams, 1904 - Remonumentation in 1984 by Stanley Skousen, as follows:

Set a USDA alu. cap 12 ins. above ground in water marked as shown using proportional dist. from sec. corner.

Set a USDA alu. cap 6 ins. above ground for WC bears: N 89°41'54"W. at 207.2 ft. dist. marked as shown

Made 2 BT's for WC

A lodgepole pine, 14 ins. diam., bears S. 13° W., 20.6 ft. dist., scribed (WC 1/4 S31 BT)

A lodgepole pine, 16 ins. diam., bears N. 62° W., 17.0 ft. dist., scribed (WC 1/4 S30 BT)

Description of Corner Evidence Found:

Both alum. cap monuments were recovered in good shape. During the course of my survey I discover a significant positional blunder error that I have fixed, the survey information will be filed on a Certificate of Survey.

Description Of Monument And Accessories Established:

The true point for the corrected 1/4 corner falls in a pond and is not monumentable. The former 1/4 cor. alum. monument was driven 3 ins. below ground and the former WC monument was left undisturbed; both former monuments now function as "Reference Monuments" to the corrected true corner position, I add no marks to either monument cap. In addition I set a witness point on the N/S centerline of sec. 30, an alum. post, 30 ins. long, 2 1/2 ins. diam., set 26 inches in the ground, with alum. Forest Service cap marked as shown. I deposit a magnet in a clear plastic case at the base of the alum. post and set a 5 ft. steel post alongside the monument. This monument is located in an open field approx. 35 ft. N. of a pond and approx. 150 ft. SE of residential buildings.

From the corrected true point for the 1/4 sec. cor.:

The new witness point alum. monument bears N. 0°12'40" E., 350.29 ft. dist..

RM-1 (the old 1/4 cor. alum. monument) bears S. 84°27'56" E., 79.47 ft. dist., no marks added.

RM-2 (the old WC alum. monument) bears S. 87°18'42" W., 127.91 ft. dist., no marks added.

WP
T16N R12W
C
S|30
C
LS9955
2013

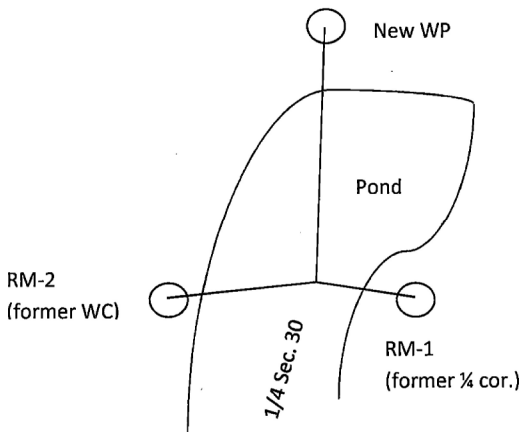

SKETCH OF CORNER

I, MICHAEL W. BEALE,
 certify the information shown herein is true and correct.
 Signature of Registered Professional Land Surveyor

I, Michael W. Beale,
 certify that this Corner Record correctly represents work performed by me or under my direction in compliance with the "Corner Recordation Act" (70-22-101, et seq., MCA)
 Signature of Surveyor & Seal

Date: 7/7/2014 Lic. No. 9955
 Employer: U.S. Forest Service

Office of Clerk and Recorder **171894 Fee: \$0.00 Bk Pg**
 record" was filed for record **POWELL COUNTY Filed 10/20/2014 At 12:20 PM**
 was noted on the cross-in **Diane S. Grey, Clk & Rcdr By [Signature]**
Return To: FILING

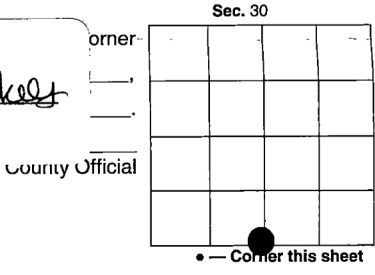

Geodetic control for this survey references the North American Datum of 1983 (NAD 83) and was established utilizing static GPS observations post-processed by the National Geodetic Survey's (NGS) Online Positioning User Service (OPUS). The geographic position of the witness point on the North-South centerline of section 30, T. 16 N., R. 12 W., as determined by survey grade GPS-RTK methods and conventional traverse methods, is:

Latitude: 47° 06' 28.515" North
Longitude: 113° 09' 56.330" West

Photographs of Corner

