

INSTRUCTIONS

1. Original and/or subsequent record used to evaluate the corner position.
2. Description of evidence found, note discrepancies in the record, state method of establishing lost or obliterated corners.
3. Description of monument and accessories set to perpetuate the corner position.
4. Sketch of corner, show all pertinent data which can best be shown in a sketch example, corner marking, topography ties, position of accessories, etc.
5. Certification must be signed and sealed by Land Surveyor registered in the State of Montana.
6. Fill in Cross Index & Section Diagram at bottom of sheet.

CERTIFIED CORNER RECORDATION

1/4 Corner SECTIONS 26 & 35 T. 16N R. 13W P.M.M. Powell County

ORIGINAL RECORD: (1898 GLO) Set a sandstone 18x8x8 ins, 12 ins. in the ground, for 1/4 sec. cor., marked 1/4 on N. face; from which:
 A tamarack, 20" diam., bears N13-1/4°E, 58 links dist., marked 1/4 S. BT
 A tamarack, 20" diam., bears S3°E, 31 links dist., marked 1/4 S. BT

SUBSEQUENT RECORD: (None)

EVIDENCE FOUND: Found a set 18"x8"x8" stone marked with "1/4" on the north side, no sign of BT's .

PERPETUATION: In place of the stone, set a 2 1/2" diameter x 30" long aluminum pipe monument with 3 1/4" aluminum cap marked as shown below and bury the stone alongside, from which establish the following new accessories:

- A 16" larch bears S83°E, a distance of 28.6 feet, scribed "1/4 S35 BT"
- A 13" douglas fir bears S24°W, a distance of 22.6 feet, scribed "1/4 S35 BT"

Set a Steel post with Forest Service Land Survey Monument and property boundary decal west and east of monument, 3 feet distant.

All BT's have BT & LSM signs, snowblazes and red painted rings.

Corner lies on a 30% south facing slope.

Date of Survey: September 2013

Compass declination 14°

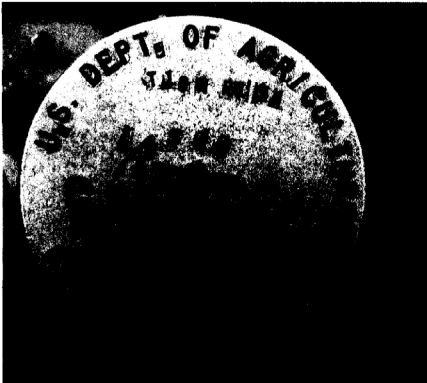

NAD 83 coordinates for this corner:
 Latitude = 47°06'24.595"N Longitude = 113°12'29.122"W
 NOTE: These coordinates are to be used as a search tool only.

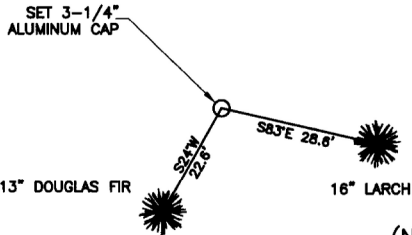

(Not to Scale)
 SKETCH OF CORNER

CERTIFICATION
 I, Henry Moua
 certify the information shown herein is true and correct.

 Signature Ground Party Chief
 I, Kurt Luebke
 certify that this Corner Record correctly represents work performed by me or under my direction in compliance with the "Corner Recordation Act" (70-22-101, et seq. M.C.A.)

 Signature of Surveyor & Seal
 Date: November 30, 2013 Reg. No. 13237
 Employer: DJ&A P. C.

Office of _____
170563 Fee: \$0.00 Bk Pg
 record# **POWELL COUNTY Filed 12/10/2013 At 10:50 AM**
 was no: **Diane S. Grey, Clk & Rcdr By Jarita Beckler**
 Return To: **FILING**
 book No. _____

 County Official

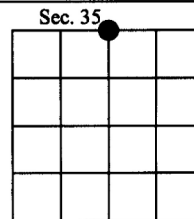

• - corner this sheet

Cross Index No. V-19 T. 16N R. 13W PMM