

CERTIFIED LAND CORNER RECORDATION

DESCRIPTION OF CORNER EVIDENCE FOUND, AND ORIGINAL RECORD (IF KNOWN)

At the Common Corner of Sections 9, 10, 15 & 16, T.16N., R.19W., Principal Meridian Montana, Lake County, Montana.

REcord: Set shale stone 18x13x9 ins. with mound.

We find: Existing fence corner, no other evidence.

DESCRIPTION OF MONUMENT AND ACCESSORIES ESTABLISHED TO PERPETUATE THE ORIGINAL LOCATION OF THIS CORNER:

Date of work: Feb. 1971

We establish this corner by section Subdivision.

To perpetuate the original location of this corner we set a 24" Copperclad mounted with stone and establish the following reference monuments:

- A Steel Post bears N.40°00'E., a dist. of 19.4 feet.
A Steel Post bears N.45°00'W., a dist. of 22.68 feet.
A Steel Post bears S.40°00'W., a dist. of 17.12 feet.
A Steel Post bears S.45°00'E., a dist. of 20.58 feet.

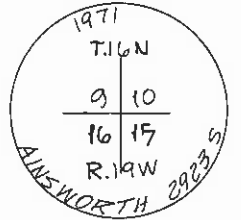

(Variance used 20°E.)

SKETCH, WITH COURSE AND DISTANCE TO ADJACENT CORNERS IF DETERMINED IN THIS SURVEY. (MAY SKETCH OR PASTE REPRODUCTION ON REVERSE SIDE.)

Surveyor's Seal

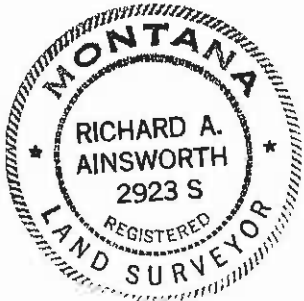

I, Elden Inabnit certify that the information shown herein is true and correct.

Signature of Ground Party Chief

I, Richard A. Ainsworth certify that I have carefully performed or reviewed the work done on the diagrammed corner as reported on this recordation form and approve the same.

Signature of Surveyor

2923S Registration Number

DIAGRAM OF CORNER:

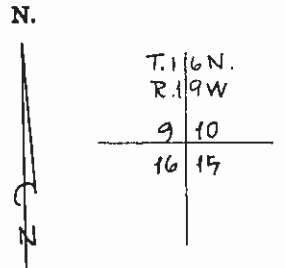

= Corner recorded on the sheet

Office of Clerk and Recorder, County of Lake

This "corner record" was filed for record on the 31st day of 10, 1971, was noted on the cross-index plat and is assigned page No. C-290, in book No. 290. ETHEL M. HARDING County Official

Cross Index No. J-13 T. 16N R. 19W Mer.