

INSTRUCTIONS

1. Original and or subsequent record used to evaluate the corner position.
2. Description of evidence found, note discrepancies in the record, state method of establishing lost or obliterated corners.
3. Description of monument and accessories set to perpetuate the corner position.
4. Sketch of corner, show all pertinent data which can best be shown in a sketch example, corner marking, topography (ies, position of accessories, etc.
5. Certification must be signed and sealed by Land Surveyor registered in the State of Montana.
6. Fill in Cross Index & Section Diagram at bottom of sheet.

CERTIFIED CORNER RECORDATION

SW Section CORNER 24  
 Corner Sec 23, 24, 25 + 26 T. 17 R. 20 P.M.M. Lake County

(GLO RECORD) set SANDSTONE 8"x7"x5", 12" IN GROUND  
 CORNER SECTIONS 23, 24, 25 + 26  
 MARKED WITH 2 NOTCHES ON SOUTH AND  
 1 NOTCH ON E EDGE RAISED A MOUND OF STONE  
 2' BASE, 1 1/2' HIGH WEST OF CORNER

1981 SURVEYOR HEGMAN VISITED SAID CORNER  
 ACCORDING TO C.O.S 3348, HE FOUND NO EVIDENCES  
 OF CORNER AND DOUBLE PROPORTION SAID SECTION  
 CORNER.

2005 I FIND NO EVIDENCE OF CORNER. I RESET SAID CORNER  
 USING SURVEYOR'S HEGMAN POSITION ACCORDING TO  
 COS 3348

I establish 3 BT'S

- A. RAILROAD Tie Bears S 30° E 25.2' FROM CORNER
- A Fence Post Bears S 20° W 23.72' FROM CORNER
- A Fence Post Bears N 24° W 21.9' FROM CORNER

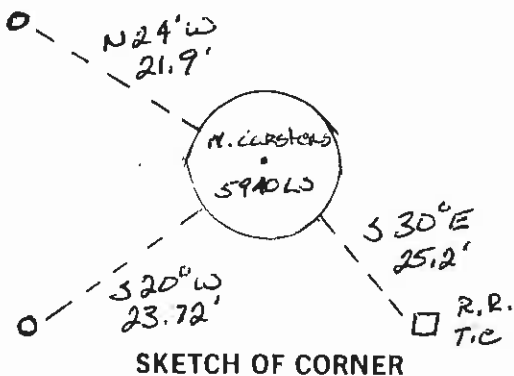

CERTIFICATION

I, Vic Robinson  
 certify the information shown herein is true and correct.  
Vic Robinson  
 Signature Ground Party

I, MARC J. CARSTENS  
 certify that this Corner Record correctly represents work performed  
 by me or under my direction in compliance with the "Corner  
 Recordation Act" (70-22-101, et seq., M.C.A.)

MARC J. CARSTENS  
 Signature of Surveyor  
 5590 L.S.  
 Date: \_\_\_\_\_ Reg. No. \_\_\_\_\_  
 Employer: \_\_\_\_\_

Office of Clerk and Recorder, County of LAKE. This "corner  
 record" was filed for record on MAR 31 2005 at 11:45 AM

was noted on the cross-index plat and is assigned page No. \_\_\_\_\_, in  
 book No. 457159 RUTH E. HODGES by Carole O'Neel  
 County Official

Cross Index No. R-21 T. 17 R. 20 P.M.M.

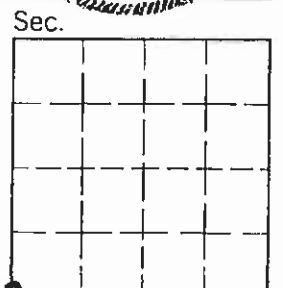

• - corner this sheet

C-2621  
 Fee - NC