

INSTRUCTIONS

1. Original and/or subsequent record used to evaluate the corner position.
2. Description of evidence found, note discrepancies in the record, state method of establishing lost or obliterated corners.
3. Description of monument and accessories set to perpetuate the corner position.
4. Sketch of corner, show all pertinent data which can best be shown in a sketch example, corner marking, topography ties, position of accessories, etc.
5. Certification must be signed and sealed by Land Surveyor registered in the State of Montana.
6. Fill in Cross Index & Section Diagram at bottom of sheet.

CERTIFIED CORNER RECORDATION

Corner Sec. Cor 7 & 18 T. 17N R. 26W P.M.M. Mineral County

ORIGINAL RECORD

1900: Set 15"x7"x6" quartzite stone 10" in the ground, marked 2 notches on north face and 4 notches on south face. From where a 6" pine bears N67½°E, 52 lks. A 10" pine bears S61°E, 80 Lks.

SUBSEQUENT RECORD

1965: BLM set brass cap on 30"x2½" iron post. From where a 8" pine bears N42 3/4°E 39 Lks.

EVIDENCE FOUND

Found BLM brass cap. Bearing trees where evident but no measurements were taken.

PERPETUATION

No perpetuation made.

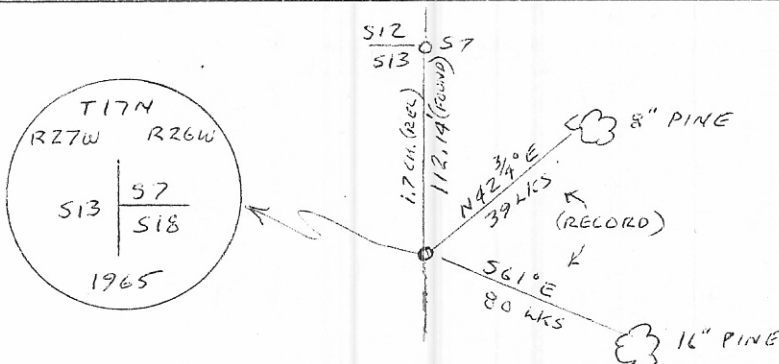

SKETCH OF CORNER

CERTIFICATION

I, Glenn R. Howard
certify the information shown herein is true and correct.

Glenn R. Howard
Signature Ground Party Clerk

I, Terry L. Druyvestein
certify that this Corner Record correctly represents work performed by me or under my direction in compliance with the "Corner Recordation Act" (70-22-201, of sec. M.C.A.)

Terry L. Druyvestein
Signature of Surveyor & Seal

Date: 12/30/86 Reg. No. 2927ES

Employer: Stensatter Druyvestein & Assoc

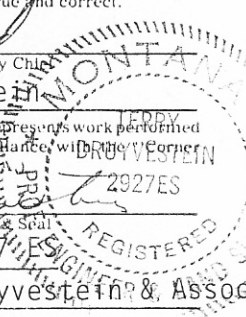

Office of Clerk and Recorder, County of _____ . This "corner record" was filed for record on Jan 6, 1987 8:02 A.M. was noted on the cross-index plat and is assigned page No. _____ , in book No. _____
Shirley Mancini By Carrie Lewis
County Official

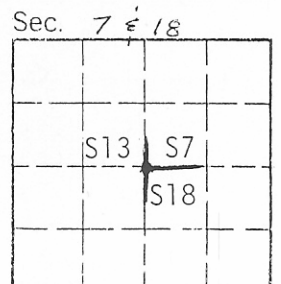

Cross Index No. J-1 T. 17N R. 26W P.M.M.

* - corner this sheet