

87490

### CERTIFIED CORNER RECORDATION

Corner W1/4 Secs. 8 T. 17 N R. 26W P.M., MT Mineral County

- I. No original record.
- II. No evidence found.
- III. The position for the West 1/4 sec, cor. for sec. 8 was determined by single proportionate measurement between the closing corner for secs. 6 and 8 and the sec. cor. for secs 7,8,17 and 18. The exact position was then located on the line between the East 1/4 sec. cor. for sec. 7 and the sec. cor. for secs. 7,8,17 and 18. At the exact corner position, as determined by survey, set a 2 1/2 in. diam. aluminum pipe, 30 ins. long, 25 ins. in the ground, with a 3 1/4 in. diam. aluminum cap, marked as shown.

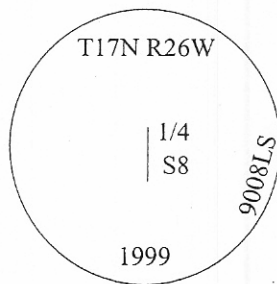

Established two new bearing trees:

A larch, 7 ins. diam., bears N.45°E., 50.1 ft. dist., marked "1/4S18 BT".

A larch 6 ins. diam., bears S.5°E., 18.5 ft. dist., marked "X BT".

Painted bearing trees and attached Land Survey Monument and Bearing Tree signs.

SEE C.O.S. NO. \_\_\_\_\_

Magnetic Declination: 17 1/2° East.

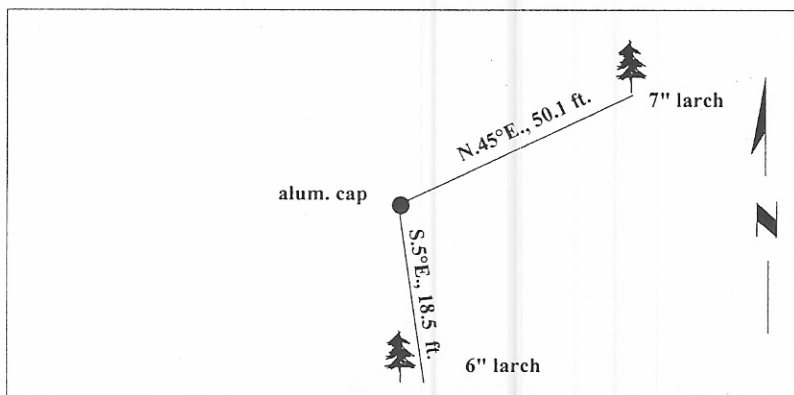

SKETCH OF CORNER

CERTIFICATION

I, **Ronald L. Benton**  
certify the information shown herein is true and correct.

*Ronald L. Benton*

---

I, **Ronald A. Pearson**  
certify that this Corner Record correctly represents work performed by me or under my direction in compliance with the "Corner Recordation Act" (70-22-101, et seq., M.C.A.)

*Ronald A. Pearson*  
Signature of Surveyor & Seal

Date: 4/26/99

Reg. No.: 9008LS

Employer: U.S. FOREST SERVICE

87490

Office of Clerk and Recorder, County of Mineral. This "corner record" was filed for record on SEP 9 1999 @ 2:53 PM and was noted on the cross-index plat and is assigned page No. \_\_\_\_\_, in book No. \_\_\_\_\_.

*Survey Manned* By Staves  
County Official

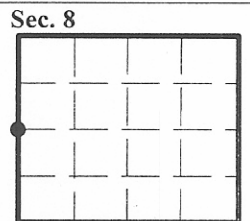

• - corner this sheet

*exempt*  
*Return to Mineral County Records*

Cross Index No. G-5 T. 17N R. 26W P.M., MT