

63595

INSTRUCTIONS

1. Original and/or subsequent record used to evaluate the corner position.
2. Description of evidence found, note discrepancies in the record, state method of establishing lost or obliterated corners.
3. Description of monument and accessories set to perpetuate the corner position.
4. Sketch or corner, show all pertinent data which can best be shown in a sketch example, corner marking, topography ties, position of accessories, etc.
5. Certification must be signed and sealed by Registered Land Surveyor in State of Montana.
6. Fill in Cross Index & Section Diagram at bottom of sheet.

CERTIFIED CORNER RECORDATION

Corner N. 1/4 S-14 T. 17 R. 27 P.M.M. Mineral County

(Record) Stone 12x10x8 ins with 1/4 on N. face
(Found) No trace of stone area has been cultivated

(Record) Pine 32" diam. bears N65°E 208 lks
(Found) No trace area has been cultivated

(Record) Pine 9" diam bears S 1 1/2°W 67 lks
(Found) No trace

Set corner by single proportion. 3" diam alum . cap with the following R.M. Tree.

26" diam Yellow Pine bears S65°W 23.8'

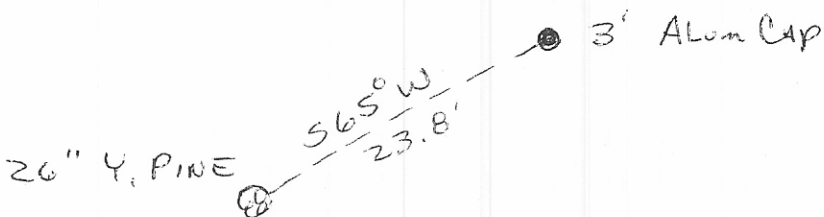
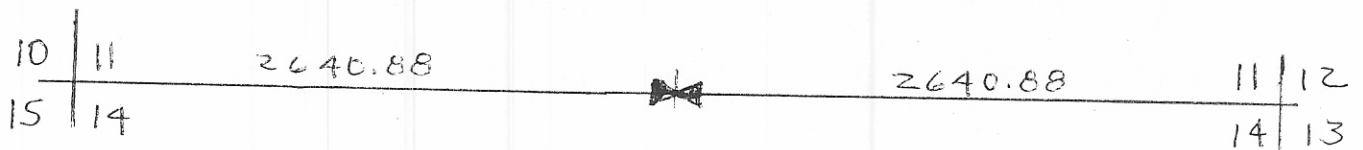

SKETCH OF CORNER

CERTIFICATION

I, _____ certify the information shown herein is true and correct.

Signature of Land Party Chief

I, GENE WARTEN certify that this Corner Record correctly represents work performed by me or under my direction in compliance with the "Corner Recordation Act" (70-22-101, et seq., M.D.A.)

Signature of Surveyor & Seal

Date: APR 4 1985

Employer: ROCKY MOUNTAIN SURVEYORS

Office of Clerk and Recorder, County of Mineral. This "corner record" was filed for record on the April 4, 1985 11:17 A.M. day of 1985, was noted on the cross-index plat and is assigned page No. _____, in book No. _____

D. Shirley Mancini
County Official

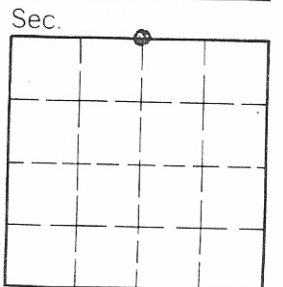

• - corner this sheet

Cross Index No. J-19 T. 17 R. 27 P.M.M.

63595