

INSTRUCTIONS

1. Original and/or subsequent record used to evaluate the corner position.
2. Description of evidence found, note discrepancies in the record, state method of establishing lost or obliterated corners.
3. Description of monument and accessories set to perpetuate the corner position.
4. Sketch of corner, show all pertinent data which can best be shown in a sketch example, corner marking, topography ties, position of accessories, etc.
5. Certification must be signed and sealed by Land Surveyor registered in the State of Montana.
6. Fill in Cross Index & Section Diagram at bottom of sheet.

CERTIFIED CORNER RECORDATION

Corner: 1/4 Corner Sections 4 & 9 T. 18N R. 20W P.M.M. Lake County

ORIGINAL RECORD (1904): Set a Sandstone, 13x8x5 ins, 9 ins. in the ground for 1/4 sec. corner, marked 1/4 on N. face.

EVIDENCE FOUND: Found original stone layed over. Accepted the position of the stone for this corner.

PERPETUATION: Set a 2 1/2" aluminum cap marked as shown in sketch with original stone alongside. Placed a MARLS tag on a fence post alongside the monument.

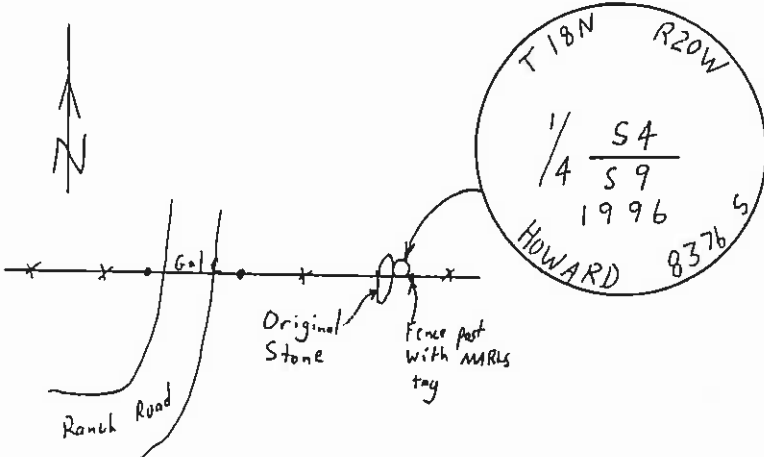

SKETCH OF CORNER

CERTIFICATION

I, Kevin Williams
 certify the information shown herein is true and correct.
Kevin Williams
 Signature Ground Party Chief

I, Glenn R. Howard
 certify that this Corner Record correctly represents work performed by me or under my direction in compliance with the "Corner Recordation Act" (70-22-10) and section 140-2-101.
Glenn R. Howard
 Signature of Surveyor & Seal

Date: 10-22-96 Reg. No. 8376 S

Employer: Druyvestein Johnson & Anderson

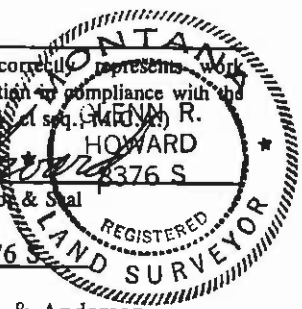

Office of Clerk and Recorder, County of Lake. This "corner record" was filed for record on OCT 23 1996 at 2:14 pm

was noted on the cross index plat and is assigned page No. 377705, in

C-2087

RUTH E. HODGES By: *Judy N. Junice*
 County Official

Cross Index No. E-11 T. 18N R. 20W PMM

Jee n/c

Sec. 4

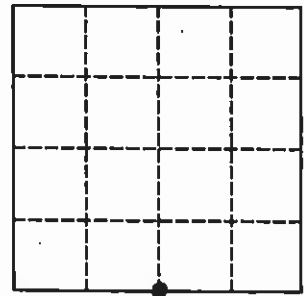

•- corner this sheet