

INSTRUCTIONS

1. Original and/or subsequent record used to evaluate the corner position.
2. Description of evidence found, note discrepancies in the record, state method of establishing lost or obliterated corners.
3. Description of monument and accessories set to perpetuate the corner position.
4. Sketch of corner, show all pertinent data which can best be shown in a sketch example, corner marking, topography ties, position of accessories, etc.
5. Certification must be signed and sealed by Land Surveyor registered in the State of Montana.
6. Fill in Cross Index & Section Diagram at bottom of sheet.

CERTIFIED CORNER RECORDATION

Corner S 1/4 Sec. 10 T. 18 N., R. 27 W. P.M.M. Mineral County

Record 1893 GLO - A Quartzite stone 14x14x8 ins. 10 ins. In the ground,...marked 1/4 on N. face, from which;
 a 10" fir bears N.34 1/4 E. 53 links
 a 12" pine bears S.22 1/2 E. 15 links

1934 NPRR plans show tie to 1/4 cor.

1969 GTW USDA recovers corner and places tags on 2 rms
 a 9" P. Pine bears N.70 W. 15',
 a 13" P. Pine bears S.60 E. 25',

1971 BPR road plans show tie to found 1/4 section corner.

1983 BPA Survey Corner recordation 2927ES "Establish the following RMs..." 2 rms per USDA Description.

Found: A marked stone lying loose on top of the ground, mrkd' side face up with "1/4" oriented to the north. It's present position is on top of a small depression. Also found numerous accessories as shown on the diagram on the reverse. The location of the loose stone / depression are in conflict with the computed location from the 1971 BPR plans. The mrkd RMs are inconsistent with the corner recordation. I determine that the depression is the original position of the stone. This position agrees with the RM to the NW and a p. pine to the SE. This tree has a small blaze and is probably the one that was initially documented in 1969, but incorrectly (probably) marked in '83. It also coincides with the pines stumps and the line trees marked at the time the stone was supposedly still set.

Set: A 3 1/4" aluminum cap in mound of stone at the position of the loose stone. Placed steel witness post. Buried mkd stone alongside the new monument. Marked tag on BT to SE "Tag Is Incorrect" Painted orange bands on all accessories. Used total station and project bearings. See diagram on reverse side.

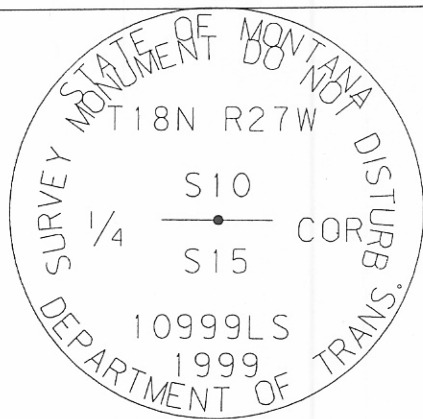

Set 3 1/4"
Alum. Cap

SKETCH OF CORNER

CERTIFICATION

I, Donald M. Roedel
certify the information shown herein is true and correct.

Signature of Ground Party Chief

I, Donald M. Roedel
certify that this Corner Record correctly represents work performed by me or under my direction in compliance with the "Corner Recordation Act" (79-22-101 et seq., MCA)

Signature of Surveyor & Seal

Date: 6/13/99 Reg. No. 10999LS

Employer: MDT

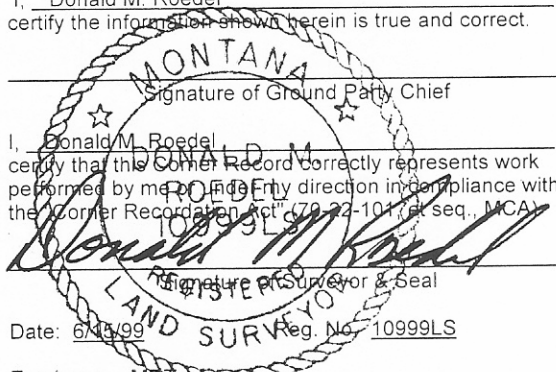

Office of Clerk and Recorder, County of Mineral. This "corner record" was filed for record on November 14, 2000 @ 10:32 AM was noted on the cross-index plat, and is assigned Page No. _____, in Book No. _____.

Katherine Jasper by Mary Yarnall
Fee Exempt County Official

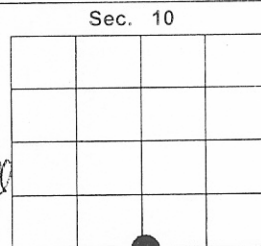

Cross Index No. J15 T. 18 N. R. 27 W., P.M.M