

- 61- 272390
- INSTRUCTIONS
- 1 Original and duplicate record used to evaluate the corner position
 - 2 Description of monument found, note discrepancies in the record, state method of setting lost or obliterated corners
 - 3 Description of monument and accessories set to perpetuate the corner position
 - 4 Sketch of corner, show all pertinent data which can best be shown in a sketch example, corner marking, topography ties, position of accessories, etc
 - 5 Certification must be signed and sealed by Registered Land Surveyor in State of Montana
 - 6 Fill in Cross Index & Section Diagram at bottom of sheet

CERTIFIED CORNER RECORDATION

Corner CC 33/54 T. 20 N. R. 20 W. P.M.M. Lake County

RECORD GLO (1905): Set a slate stone, 14x10x8 ins., 9 ins. in the ground, for closing cor. of secs. 4 and 5, marked CC on S., with 4 grooves on E. and 2 grooves on W. face; dig pits, 24x18x12 ins., crosswise on each line, E. and W., 3 ft., and S. of stone, 7 ft. dist., and raise a mound of earth, 4 ft. base, 2 ft. high S. of cor.

FOUND: No evidence found; position falls in R/W State Highway 211 [F.A.S. S-306(2)].

SET: 2 1/2" pipe with 2 1/2" aluminum cap stamped as shown. Positioned 15' north of centerline F.A.S. S-306(2) per plans and centerline of road to south. See reverse side for ties to other corners.

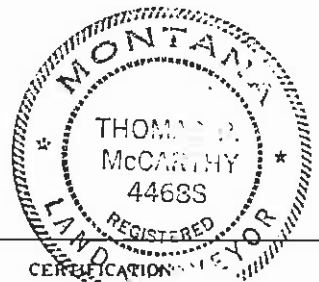
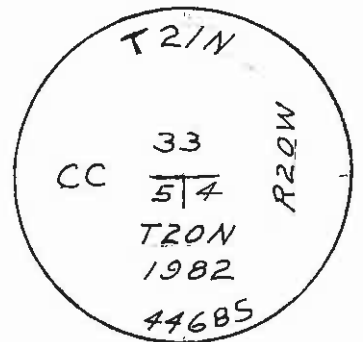

William W. Weikel, L.S.
 certify the information shown herein is true and correct.
 Signature Ground Party Chief

Thomas P. McCarthy
 certify that this Corner Record correctly represents work performed by me or under my direction in compliance with the "Corner Recordation Act" (70-22-101, et seq., M.C.A.)
 Signature of Surveyor & Seal

Date 1/83 Reg No 4468S
 Employer: Sorenson & Company

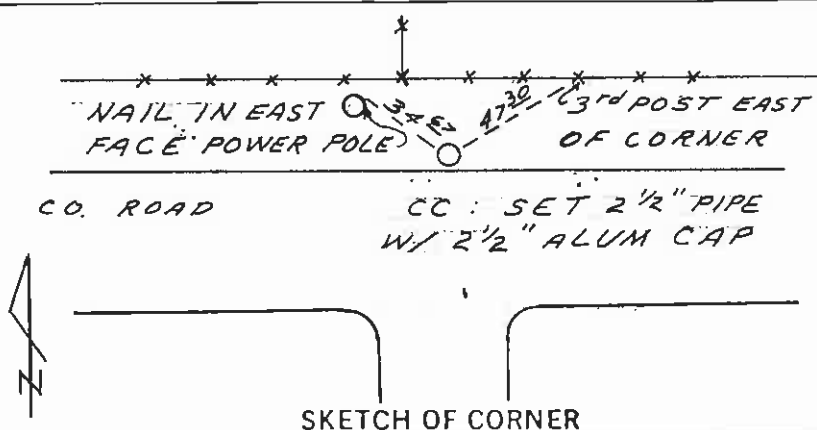

Office of Clerk and Recorder, County of Lake State of Montana. This "corner record" was filed for record on ~~the~~ FEBRUARY 1, 1983 at 8:40 A.M. was noted on the cross-index plat and is assigned page No. 272390, in book No. C-1199 By: Ethel M. Harding, Lake County Clerk & Recorder
Harold W. Wilson, Deputy County Official

