

INSTRUCTIONS

1. ...nal and/or subsequent record used to evaluate the corner position.
2. Description of evidence found, note discrepancies in the record, state method of establishing lost or obliterated corners.
3. Description of monument and accessories set to perpetuate the corner position.
4. Sketch of corner, show all pertinent data which can best be shown in a sketch example, corner marking, topography ties, position of accessories, etc.
5. Certification must be signed and sealed by Land Surveyor registered in the State of Montana.
6. Fill in Cross Index & Section Diagram at bottom of sheet.

CERTIFIED CORNER RECORDATION

Corner: 1/4 Corner Sections 28 & 29 T. 20N R. 26W P.M.M. Sanders County

ORIGINAL RECORD (1886): Set a post.

EVIDENCE FOUND: Stone with 1/4 scribed in South face. This stone was used by other surveyors as the accepted location for this corner.

PERPETUATION: Placed a MARLS tag on a fence post bearing West, 1.0 feet.

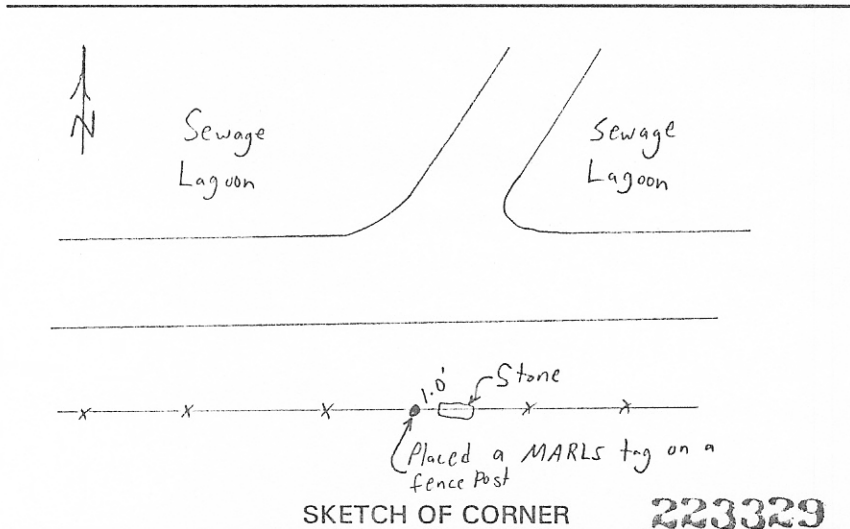

CERTIFICATION

I, Kevin Williams
 certify the information shown herein is true and correct.
Kevin Williams
 Signature Ground Party Chief

I, Glenn R. Howard
 certify that this Corner Record correctly represents work performed by me or under my direction in compliance with the "Corner Recordation Act" (70-22-101, et seq., M.C.A.)
Glenn R. Howard
 Signature of Surveyor & Seal

Date: 9-20-96 Reg. No. 8376 S

Employer: Druyvestein Johnson & Anderson

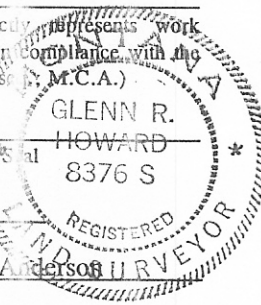

Office of Clerk and Recorder, County of Sanders. This "corner record" was filed for record on Sept. 26, 1996 at 1:50 pm was noted on the cross index plat and is assigned page No. _____, in book No. 4 356 Tillie W. Weston By: Ronil A. Wright County Official

no fee

Cross Index No. T-9 T. 20N R. 26W P.M.M.

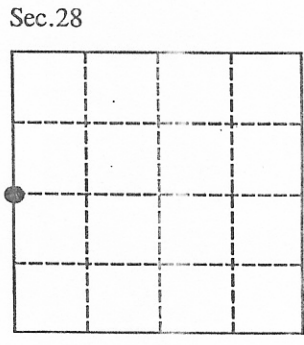

•- corner this sheet