

INSTRUCTIONS

1. Original and/or subsequent record used to evaluate the corner position.
2. Description of evidence found, note discrepancies in the record, state method of establishing lost or obliterated corners.
3. Description of monument and accessories set to perpetuate the corner position.
4. Sketch of corner, show all pertinent data which can best be shown in a sketch example, corner marking, topography ties, position of accessories, etc.
5. Certification must be signed and sealed by Land Surveyor registered in the State of Montana.
6. Fill in Cross Index & Section Diagram at bottom of sheet.

CERTIFIED CORNER RECORDATION

Corner 7 26/25 T. 20N. R. 26W. P.M.M. SANDERS County

RECORD: 1886. Set a limestone, 18x6x4 ins., 12 ins. in the ground, marked $\frac{1}{4}$ S on W. face.

Raise a mound of rock alongside.

RECORD: 1979, S.J.SKOUSEN, 2532S. Found a set stone marked "U 7" on W. face.

Found a mound of stone alongside.

Replaced the set stone with a standard USDA aluminum pipe with $3\frac{1}{4}$ in. diam. cap 6 ins. above ground marked as shown.

Buried original stone alongside the monument.

Placed Attention sign on steel fence post next to monument.

Raised a mound of stone around the monument.

Painted rock mound red.

No trees with limits.

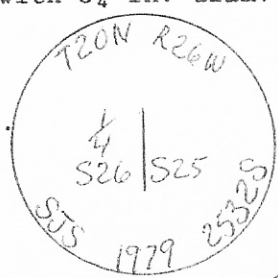

FOUND: 1997. A USDA alum. cap 12 ins. above the ground marked:

Mound of stones around cap.



PERPETUATION: Set found cap 1 inch below the ground surface with original stone alongside. NOTE: A homesite is planned at the corner position.

Set two witness caps(USDA alum. rod $3/4$ inch dia. by 30 ins. long with $3\frac{1}{4}$ inch dia. alum. caps attached) marked:

A cap bears N.62°W., 90.0 ft. marked:

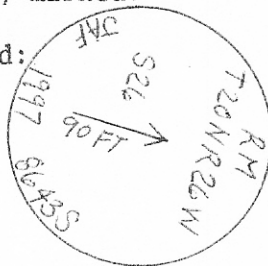

A cap bears S.4°E., 126.0 ft. marked:

Decl. $17\frac{1}{2}$ °E.

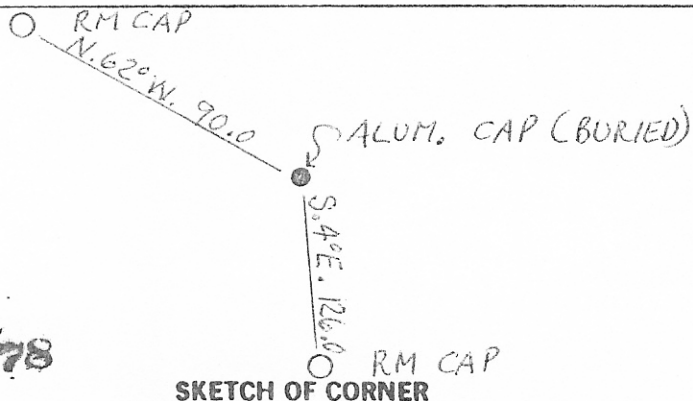
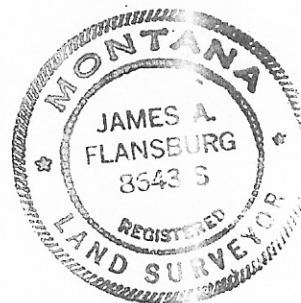
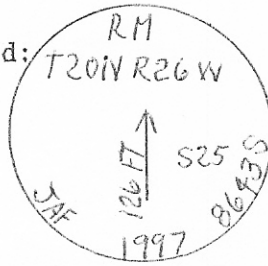

238778

SKETCH OF CORNER

CERTIFICATION

I, EDDO M. FLURI

certify the information shown herein is true and correct.

Eddo M. Fluri
Signature Ground Party Chief

I, JAMES A. FLANSBURG

certify that this Corner Record correctly represents work performed by me or under my direction in compliance with the "Corner Recordation Act" (70-22-101, et seq., M.C.A.)

James A. Flansburg
Signature of Surveyor & Seal

Date: 1-2-98 Reg. No. 8643S

Employer: _____

Office of Clerk and Recorder, County of SANDERS. This "corner

record" was filed for record on Feb. 23, 1998 at 8:32am

was noted on the cross-index plat and is assigned page No. _____, in

book No. 1 536

Tillie W. Weston, By: Pam A. Whyte
County Official

Sec. 26

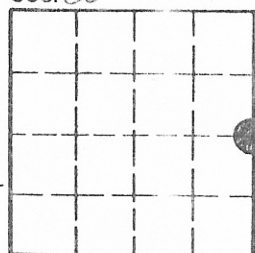

Cross Index No. T-21 T. 20N. R. 26W. P.M.M.

• - corner this sheet

No Fee