

CERTIFIED CORNER RECORDATION

Corner 1/4 **Secs.** 5/8 **T.** 21 N. **R.** 29 W. **P.M., MT** **Sanders** **County**

I. 1889 G.L.O. RECORD by George K. Reeder: Set a porphyry stone 18x8x7 ins. 12 ins. in the ground for 1/4 sec. com. marked 1/4 on N. face from which

A pine tree 12 ins. diam., bears N.51°10'W., 70 lks.(46.20 ft.) dist., marked 1/4 SBT.
A fir tree 14 ins. diam., bears S.88°50'E., 42 lks.(27.72 ft.) dist., marked 1/4 SBT.

II. FOUND 2001: A stone, 7x10 ins., 6 inches above the ground firmly set with an open "1/4" on North face.

No evidence of Sec. 5 BT.

A 12 inch dia. cut pine stump bears East, 28.9 ft. no scribing visible. (Record: fir tree)

A 1/2 inch dia. rebar with a 1 1/4 inch dia. yellow plastic cap marked "Warren 2734S" bears N.89°46'E., 12.79 ft. This is a lot corner for a lot in Sec. 8.

III. At the position of the found stone set a std. U.S.D.A. aluminum pipe 2 1/2 ins. dia. by 30 ins. long with a 3/4 in. diam. aluminum cap 8 inches above the ground marked as shown:
Buried the stone alongside the aluminum pipe.

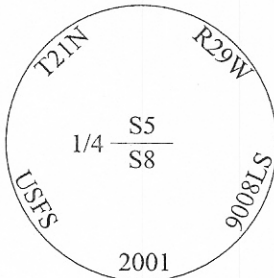

Established two new bearing trees:

No trees to the South for a new bearing tree.

A p.pine 10 ins. diam., bears N.70°E., 39.75 ft. dist., marked. " 1/4S5BT".

A p. pine 8 ins. diam. bears N.41°W., 25.25 ft. dist., marked " 1/4S5BT".

Painted bearing trees red and attached Land Survey Monument and Bearing Tree signs.

Magnetic Declination: 18° East.

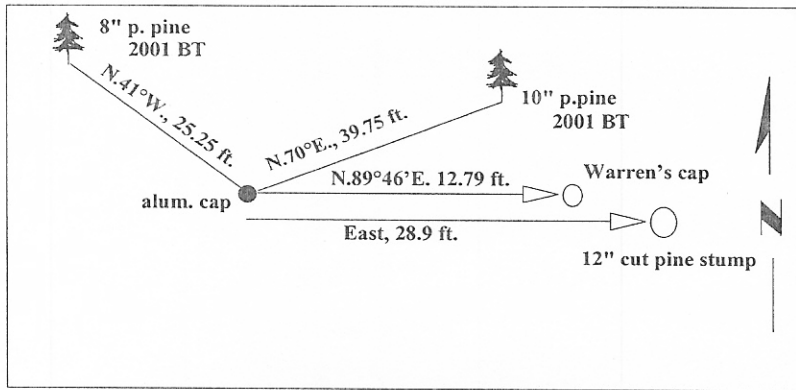
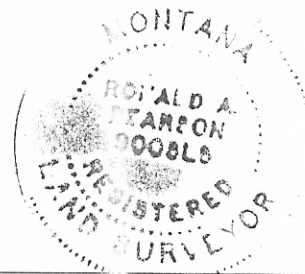

SKETCH OF CORNER

CERTIFICATION

I, Ronald L. Benton
certify the information shown herein is true and correct.

Ronald L. Benton

I, Ronald A. Pearson
certify that this Corner Record correctly represents work performed by me or under my direction in compliance with the "Corner Recordation Act" (70-26-101, et seq., M.C.A.)

Ronald A. Pearson
Signature of Surveyor & Seal

Date: 05/08/2001

Reg. No.: 9008LS

Employer: U.S. FOREST SERVICE

242348

Office of Clerk and Recorder, County of Sanders. This "corner record" was filed for record on May 14, 2001 @ 9:40 A.M. and was noted on the cross-index plat and is assigned page No. _____,

in book No. 4 819 Pat Ingraham by: Pat Ingraham, Deputy
County Official

