

**INSTRUCTIONS**

1. Original and/or subsequent record used to evaluate the corner position.
2. Description of evidence found, note discrepancies in the record, state method of establishing lost or obliterated corners.
3. Description of monument and accessories set to perpetuate the corner position.
4. Sketch of corner, show all pertinent data which can best be shown in a sketch example, corner marking, topography ties, position of accessories, etc.
5. Certification must be signed and sealed by Land Surveyor registered in the State of Montana.
6. Fill in Cross Index & Section Diagram at bottom of sheet.

**CERTIFIED CORNER RECORDATION**

Corner 1/4 COMMON TO SECTION T. 22 N. R. 19 W. P.M.M. LAKE County  
19 & 20

ORIGINAL RECORD: NO ORIGINAL EVIDENCE FOUND. CORNER FALLS WITHIN CONSTRUCTION LIMITS OF COUNTY ROAD.

FOUND: A 5/8" DIAM. STEEL PIN BY RLS # 2229 S. TOP BENT OVER BY ROAD MAINTENANCE EQUIPMENT.

SET: A 5/8" DIAM. REBAR WITH PLASTIC CAP STAMPED "MARENGO LS 9012." REBAR SET IN VERTICAL POSITION OF PREVIOUS 5/8" STEEL PIN MONUMENTATION.

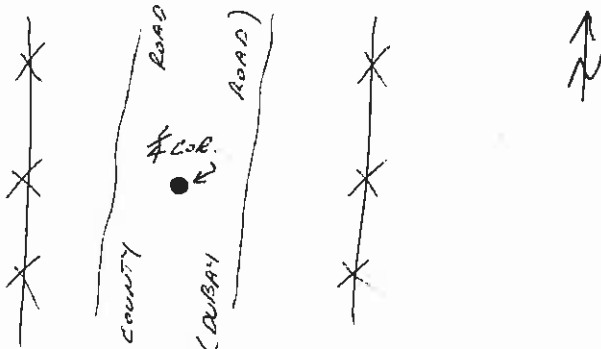

SKETCH OF CORNER

**CERTIFICATION**

I, GREGORY B. MARENGO  
certify the information shown herein is true and correct.

Signature Ground Party Chief

I, GREGORY B. MARENGO  
certify that this Corner Record correctly represents work performed by me or under my direction in compliance with the "Corner Recordation Act" (70-22-101, et seq., M.C.A.)

Gregory B. Marengo  
Signature of Surveyor & Seal

Date: 2/5/90 Reg. No. 9012 S

Employer: MARENGO SURVEYING

Office of Clerk and Recorder, County of Lake. This "corner record" was filed for record on Feb 6 '90 at 9:05 A.M. was noted on the cross-index plat and is assigned microfilm# 322447, in

C-1708  
N/C

LORIN JACOBSON By Paula Holle, deputy  
County Official

Cross Index No. P-5 T. 22 N. R. 19 W. P.M.M.

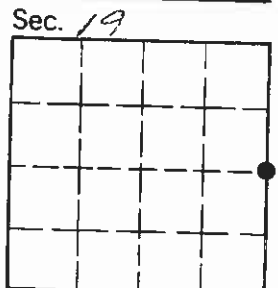

• - corner this sheet