

INSTRUCTIONS

1. Original and/or subsequent record used to evaluate the corner position.
2. Description of evidence found, note discrepancies in the record, state method of establishing lost or obliterated corners.
3. Description of monument and accessories set to perpetuate the corner position.
4. Sketch of corner, show all pertinent data which can best be shown in a sketch example, corner marking, topography ties, position of accessories, etc.
5. Certification must be signed and sealed by Land Surveyor registered in the State of Montana.
6. Fill in Cross Index & Section Diagram at bottom of sheet.

**CERTIFIED CORNER RECORDATION**

Corner Sections 35, 36, 1 & 2 T. 21 & 22 N. R. 30 W. P.M.M. Sanders County

ORIGINAL RECORD: (G.L.O.)  
 Set a post 4 ft. long, 4 ins. sq., 24 ins. in the ground for cor. to secs. 1, 2, 35, and 36, marked T. 22 N., S. 36 on N.E., R. 30 W., S. 1 on S.E., T. 21 N., S. 2 on S.W., and S. 35 on N.W. faces, with 1 notch on E. and 5 on W. edges from which:  
 A fir, 10 ins. diam., bears N 61° 30' E, 11 lks dist. marked T. 22 N., R. 30 W., S 36 BT.  
 A fir, 12 ins. diam., bears S 18° E, 31 lks. dist. marked T. 21 N., R. 30 W., S 1 BT.  
 A tamarack, 20 ins. diam., bears S. 85° 5' W., 41 lks. dist. marked T. 21 N., R. 30 W., S 2 BT.  
 A tamarack, 16 ins. diam., bears N. 42° 40' W., 42 lks. dist. marked T. 22 N., R. 30 W., S 35 BT.

SUBSEQUENT RECORD: (1974 Recordation Form #137367)  
 Surveyor Stanley Skousen found:  
 A 15 in. larch stump bears S. 85° W., 27.1 feet, scribe visible.  
 A 14 in. stump bears N. 38° 40' W., 26.7 feet, no scribing.  
  
 Set 2" G.I. Pipe with 2 1/2" brass cap 5 ins. above ground with rocks piled around base, marked as 5.0 ft. RM to sec. cor. SJS 2532S from which:  
 A 14 in. W. fir bears S. 13° W., 28.3 ft., scribed "RM".  
 A 17 in. W. fir bears N. 84° 30' W., 24.1 ft., scribed "RM".

EVIDENCE FOUND: Found 2 1/2" Brass Cap (marked as shown below) from which:  
 A 3 1/4" Aluminum Cap marked as 5.0 ft RM SJS 2532S, 0.1' above ground in mound of rocks bears N. 62° W., 4.75 feet dist.  
 A RR tie fence post bears N., 1.45 feet dist.

PERPETUATION: Left corner as found and established a latitude and longitude for search purposes.

Date of Survey: November, 2008.

NAD 83 coordinates for this corner:  
 Latitude = 47°36'52.88487 "N Longitude = 115°23'49.95412"W  
 NOTE: These coordinates are to be used as a search tool only.

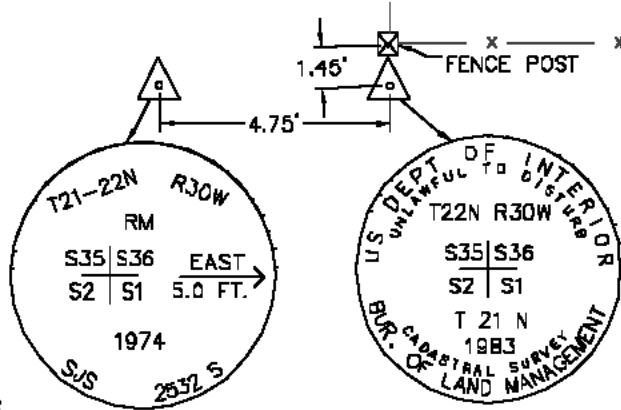

(Not to Scale)  
**SKETCH OF CORNER**

CERTIFICATION

I, Steve Cummings  
 certify the information shown herein is true and correct.

\_\_\_\_\_  
 Signature Ground Party Chief

I, Kurt A. Luebke  
 certify that this Corner Record correctly represents work performed by me or under my direction in compliance with the "Corner Recordation Act" (70-22-101, et seq., M.C.A.)

\_\_\_\_\_  
 Signature of Surveyor & Seal

Date: 12-10-2008 Reg. No. 13237 S

Employer: DJ&A P. C.

Office of Clerk and Recorder, County of Sanders. This "corner record" was filed for record on \_\_\_\_\_ was noted on the cross index plat and is assigned page No. \_\_\_\_\_, in book No. \_\_\_\_\_

County Official

Cross Index No. Z-21 T. 21 N. R. 30 W. PMM  
 Cross Index No. A-21 T. 22 N. R. 30 W. PMM

