

CERTIFIED LAND CORNER RECORDATION

218338

DESCRIPTION OF CORNER EVIDENCE FOUND, AND ORIGINAL RECORD (IF KNOWN)

Original record: Set a trap stone 18x10x9 ins 12 ins. in the ground, for Cor of Secs. 16,17,20,21 marked with 3 notches on S and 4 notches on E edges, from which, A Fir bears, 8 inches in diam, N38²⁰E 71 links dist, marked T25N R22W S 16 BT; A Tamarack 10 ins. diam, bears S72 ¹/₄E 129 links dist. marked T25N R22W S21 BT, A Pine 8 inches in diam, bears S72 ³/₄W 88 links dist. marked T25N R22W S20 BT. , A Tamarack 8 inches in diam. bears N61 ³/₄ W 101 links dist. marked T25N R22W S17 BT..

Found: A Pine which is now 12 inches in diam, with face chopped open scribing plainly visible, which is the bearing tree for the southwest quad. I reset the corner from this BT at the record bearing and distance. No other evidence of the corner found.

DESCRIPTION OF MONUMENT AND ACCESSORIES ESTABLISHED TO PERPETUATE THE ORIGINAL LOCATION OF THIS CORNER:

I scribed a 8 inch Douglas Fir T25N R22W S21BT.

Date of work: 6/6/74

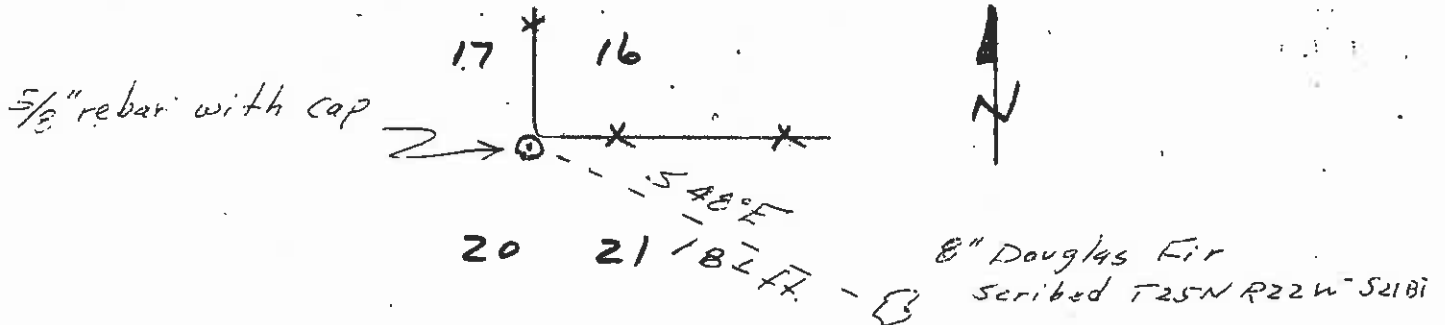

SKETCH, WITH COURSE AND DISTANCE TO ADJACENT CORNERS IF DETERMINED IN THIS SURVEY. (MAY SKETCH OR PASTE REPRODUCTION ON REVERSE SIDE.)

See Certificate of Survey #2293

Surveyor's Seal

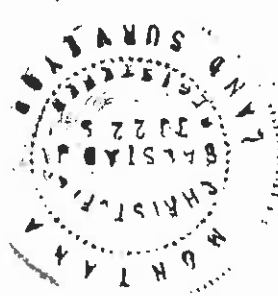

I, _____, certify that the information shown herein is true and correct.

Signature of Ground Party Chief

I, Christopher Balstad Jr., certify that I have carefully performed or reviewed the work done on the diagrammed corner as reported on this recordation form and approve the same.

Christopher Balstad Jr.
Signature of Surveyor

DIAGRAM OF CORNER:

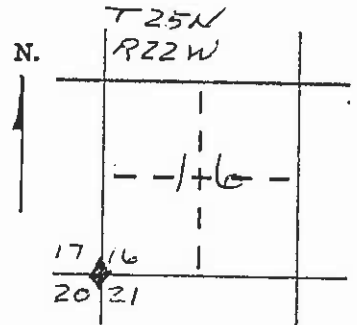

◆ = Corner recorded on the sheet

33225
Registration Number

of Clerk and Recorder, County of Lake

"corner record" was filed for record on the AUG 19 1974 day of 3:45 PM, was noted on the cross-index plat and is recorded page No. _____, in book No. C-519

ETHEL M. HARDING
County Official

Cross Index No. NE9 T. 25 N. R. 22 W. Mer.