

CERTIFIED LAND CORNER RECORDATION

218333

DESCRIPTION OF CORNER EVIDENCE FOUND, AND ORIGINAL RECORD (IF KNOWN)

Original record: Set a Fir post 3 ft. long, 4 ins. square, 24 inches in the ground for Cor. of Secs. 8,9,16,17 marked; T.25N S9 on N.E. R.22 W 16 on S.E. , S17 on S.W. and S8 on N.W. faces with 4 notches on S and E edges from which ;; A Fir 14 ins. diam. bears N70E 12 links dist. marked T.25N. R.22W. S.9 B.T. A Fir 10 ins. diam. bears S36 1/2 E 42 links dist. marked T.25N. R.22 W. S 16 B.T. A Fir 14 ins. diam. bears S33 1/4 W 52 links dist marked T.25N. R.22W. S17 B.T. A Fir 14 ins. diam. bears N 27 1/4 W 54 lks. dist. marked T.25N. R.22W. B.T. S8 B.T.

Found: B.T. stumps in the NW and SW quads, and set a 5/8" rebar and plastic cap from these stumps using the record distances. No evidence found of original corner, or BT's in the NE and SE quads. A fence intersection is in the same location.

DESCRIPTION OF MONUMENT AND ACCESSORIES ESTABLISHED TO PERPETUATE THE ORIGINAL LOCATION OF THIS CORNER:

Date of work: 6/29/74

I marked a Western Larch T25N R22W S 17 BT which bears S33W 33.3 ft. from the corner. Also scribed was a Ponderosa Pine T25N R22W S16 BT which bears S34E 43.5 ft. The original BT in the NW quad is still standing, as nag still in pretty good shape.

SKETCH, WITH COURSE AND DISTANCE TO ADJACENT CORNERS IF DETERMINED IN THIS SURVEY. (MAY SKETCH OR PASTE REPRODUCTION ON REVERSE SIDE.)

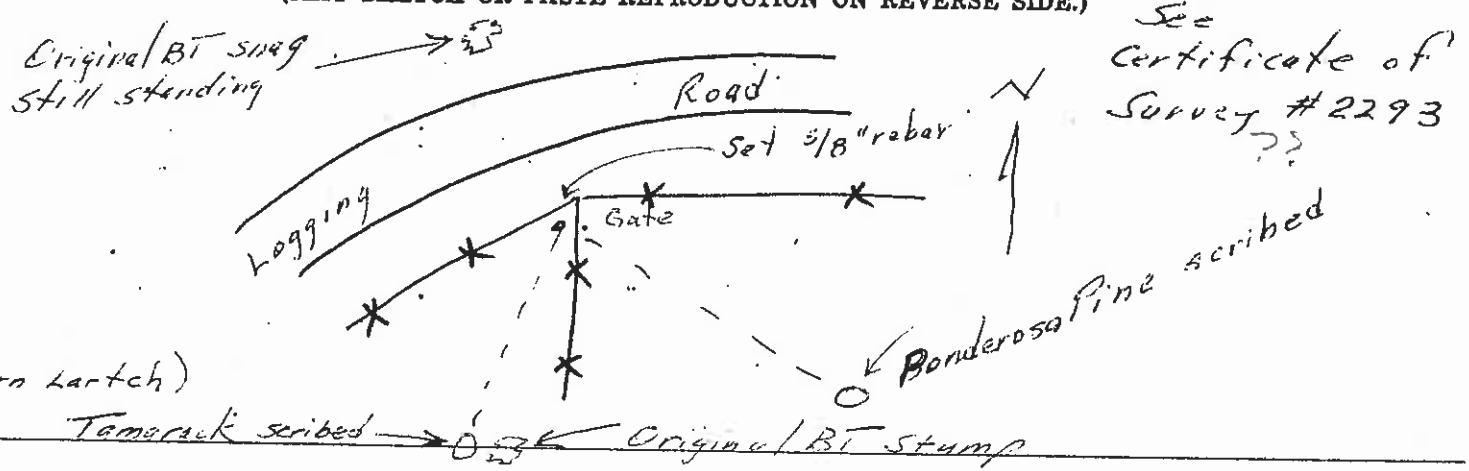

I, _____, certify that the information shown herein is true and correct.

Signature of Ground Party Chief

I, Christopher Balstad, Jr. certify that I have carefully performed or reviewed the work done on the diagrammed corner as reported on this recordation form and approve the same.

Christopher Balstad, Jr.
 Signature of Surveyor

DIAGRAM OF CORNER:

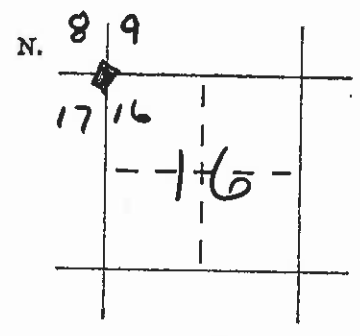

◆ = Corner recorded on the sheet

33225
 Registration Number

County of Clerk and Recorder, County of Lake
 "corner record" was filed for record on the AUG 19 1974 day of 3:32 PM
 was noted on the cross-index plat and is
 signed page No. C-514
 ETHEL M. HARDING
 County Official
 Cross Index No. T-9 T. 25 N. R. 22 W Mer.