

INSTRUCTIONS

437359

1. Original and/or subsequent record used to evaluate the corner position.
2. Description of evidence found, note discrepancies in the record, state method of establishing lost or obliterated corners.
3. Description of monument and accessories set to perpetuate the corner position.
4. Sketch of corner, show all pertinent data which can best be shown in a sketch example, corner marking, topography ties, position of accessories, etc.
5. Certification must be signed and sealed by Land Surveyor registered in the State of Montana.
6. Fill in Cross Index & Section Diagram at bottom of sheet.

CERTIFIED CORNER RECORDATION

CORNER NE SECTION 19 T 26 R 19W PMM LAKE COUNTY

RECORD: GLO: FRENCH (1975)

FOUND SLATE STONE, 8x8x4" ABOVE GROUND FROM WHICH:

A FIR 11 INS DIAM. BEARS N39°45'E, 35 LKS ;A FIR 9 INS DIAM. BEARS S62°30'E, 41 LKS DISTANT

A FIR 6 INS DIAM. BEARS S37°30'W, 27 LKS; A FIR 7 INS DIAM. BEARS N54°W, 43 LKS DISTANT

SUBSEQUENT RECORD: CORNER RECORDATION FORM BY MARQUARDT DATED 3/1/71

FOUND AND USED 6" SQUARE CONCRETE POST

FOUND: 3 1/4" BRASS CAP ON A 2 1/2" STEEL PIPE, 8" ABOVE GROUND, WITH PILE OF STONES AROUND BASE AND STAMPED AS SHOWN BELOW:

4 1/2"x 5" CONCRETE POST WITH 1" SQUARE IN THE MIDDLE, 16" ABOVE GROUND, BEARS S80°W, 1.0 FOOT

12" FIR WITH BLAZE AND BT TAG BEARS N59°W, 28 FEET SLOPE DISTANCE

14" FIR WITH BLAZE AND BT TAG BEARS N39°E, 22.9 FEET DISTANT

15" FIR WITH BLAZE AND BT TAG BEARS S66E, 27.0 FEET DISTANT

16" FIR STUMP WITH VISIBLE SCRIBE BEARS S14°E, 26.5 FEET DISTANT

6" FIR WITH BLAZE AND BT TAG BEARS S19°W, 17.9 FEET DISTANT

DOUBLE (SPLIT) 12" FIR WITH LOCATION TAG BEARS S48°W, 1.6 FT DISTANT

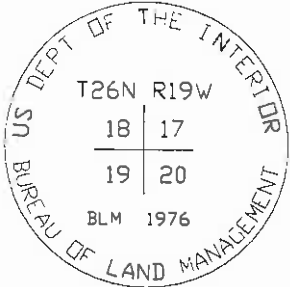

SET: NOTHING : CONTROL POINT 134 FOR WGM GROUP, INC. PROJECT #990614

NOTE: ALL COMPASS BEARINGS ARE TRUE; 16° EAST DECLINATION SET.

ALL DISTANCES NOTED ARE HORIZONTAL UNLESS NOTED. WHEN REFERENCING BEARING TREES OR POWER POLES, DISTANCES WERE MEASURED TO THE FACE OF THE OBJECT.

SKETCH OF CORNER

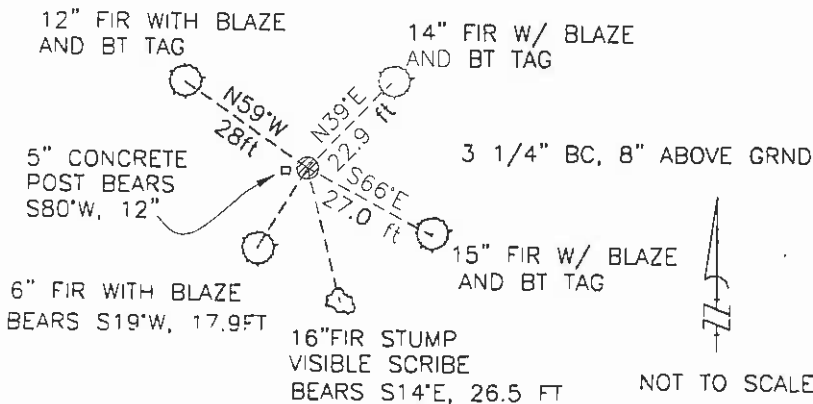

CERTIFICATION

I, David Vietz
certify the information shown herein is true and correct.

David Vietz
Signature Ground Party Chief

I, Greg A. LaZerte, LS
certify that this Corner Record correctly represents work performed by me or under my direction in compliance with the "Corner Recordation Act" (70-22-101, et seq., M.C.A.)

Greg A. LaZerte
Signature of Surveyor & Seal

Date: 5/12/2003 Reg. No. 14725LS

Employer: WGM Group, Inc.

Office of Clerk and Recorder, County of Lake This "corner

record" was filed for record on the JUN 24 2003 at 3:58 PM day of 20

was noted on the cross-index plat and is assigned Page No. 437359 in

Book No. RUTHE HODGES By Judy Muniz dep County Official

Cross Index No. N-5 T 26 R 19W PMM

Sec. 19

• - Corner this sheet