

INSTRUCTIONS

1. Original and/or subsequent record used to evaluate the corner position.
2. Description of evidence found, note discrepancies in the record, state method of establishing lost or obliterated corners.
3. Description of monument and accessories set to perpetuate the corner position.
4. Sketch of corner, show all pertinent data which can best be shown in a sketch example, corner marking, topography ties, position of accessories, etc.
5. Certification must be signed and sealed by Land Surveyor registered in the State of Montana.
6. Fill in Cross Index & Section Diagram at bottom of sheet.

CERTIFIED CORNER RECORDATION

Corner W 1/4 Cor. Sec. 1

T. 28N, R. 3W P.M.M. Pondera County

Record - GLO
1874

Set a boulder 12 x 7 x 6 in., 8 in. in the ground for 1/4 Sec. Cor. marked '1/4' on the West side.

Found - MDT
1998

Found record stone firmly set, weathered but scribed "1/4" on West face.

- stone is surrounded by a mound of stones,
- 200m East of centerline strip at milepost 2.209 on the frontage road North of Conrad,
- 1.6m East of a fenceline, and 76m Northerly of the centerline of the nearest set of railroad tracks to the South.

Set - MDT 1998

Witness post with MDT decal set 0.3m North of stone.

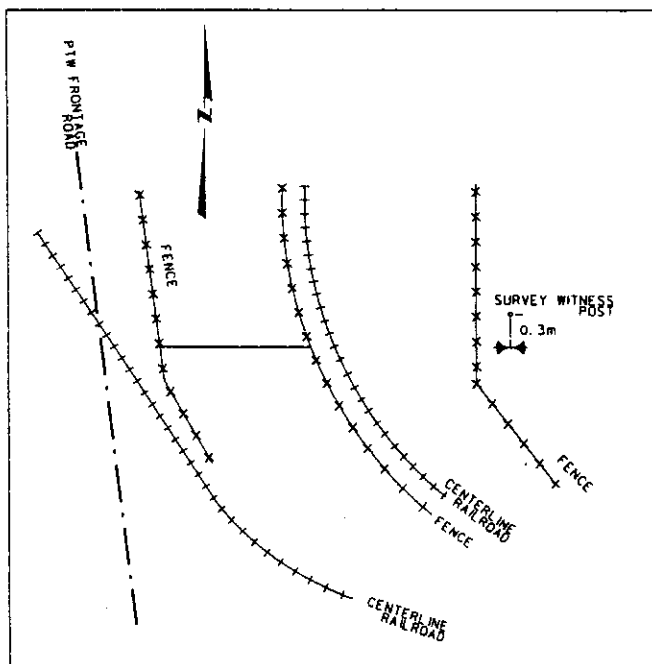

CERTIFICATION

I, Shon Henderson
certify the information shown herein is true and correct.

Signature of Ground Party Chief

I, DAVID
certify that this Corner Record correctly represents work performed by me or under my direction in compliance with the "Corner Recordation Act" (MCA)

Signature

Date: 3/99

Employer: MDT

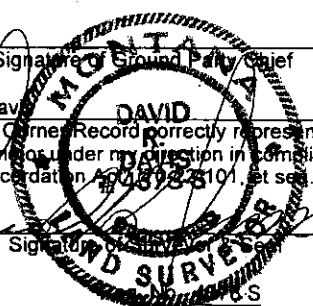

SKETCH OF CORNER

Office of Clerk and Recorder, County of _____ This "corner record" was filed for record on _____ was noted on the cross-index plat, and is assigned Page No. _____, in Book No. _____

County Official

Sec. 1

• - Corner this sheet

Cross Index No. C-21 T. 28N R. 3W, PMM