

INSTRUCTIONS

1. Original and/or subsequent record used to evaluate the corner position.
2. Description of evidence found, note discrepancies in the record, state method of establishing lost or obliterated corners.
3. Description of monument and accessories set to perpetuate the corner position.
4. Sketch of corner, show all pertinent data which can best be shown in a sketch example, corner marking, topography ties, position of accessories, etc.
5. Certification must be signed and sealed by Land Surveyor registered in the State of Montana.
6. Fill in Cross Index & Section Diagram at bottom of sheet.

**CERTIFIED CORNER RECORDATION**

Corner 1/4 COR.TO SEC'S.20 &21

T. 32N., R. 6E., P.M.M.

LIBERTY County

RECORD GLO 1897

Set a granite stone, 15"x9"x7", 10" in the ground, for the 1/4 Sec. Cor., marked 1/4 on West face. Dig pits 18"x18"x12" North and South of stone, 3' dist. And raise a mound of earth 3-1/2' base, 1-1/2' high, West of corner.

FOUND MDT 2001

No evidence of the original monument found.

SET MDT 2002

Quarter-corner position located by single proportionate measurement, which falls in a cultivated field. At this position set a 3 1/4"x 30" aluminum monument, 9" below the ground. Set a witness post with MDT decal 10' West of said monument.

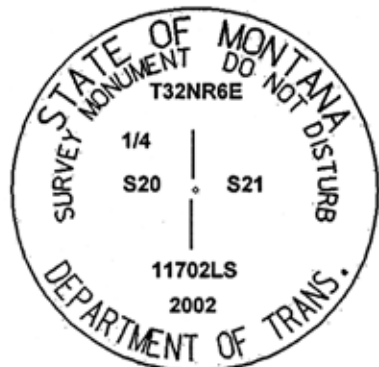

See Certificate of Survey Number 120350

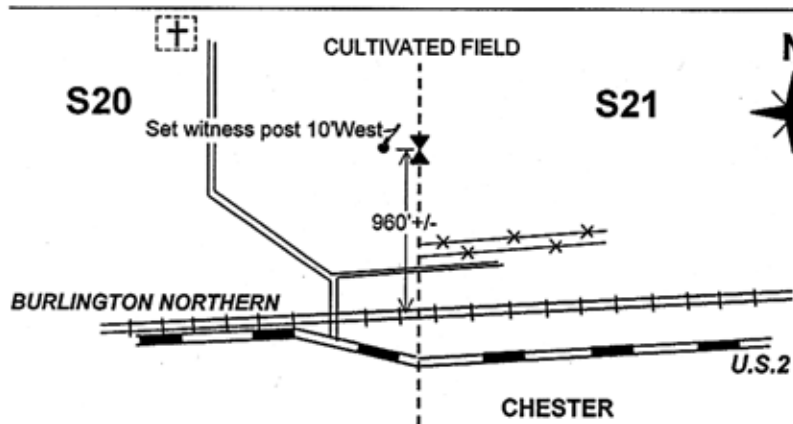

SKETCH OF CORNER

CERTIFICATION

I, Timothy A. Ferguson  
certify the information shown herein is true and correct.

*[Signature]*  
Signature of Ground Party Chief

I, Theodore M. Brown  
certify that this Corner Record correctly represents work performed by me or under my direction in compliance with the "Corner Recordation Act" (70-22-121, et seq., MCA)

*[Signature]*  
Signature of Surveyor & Registered Surveyor

Date: 12/11/02 Reg. No. 11702LS

Employer: Montana Department of Transportation

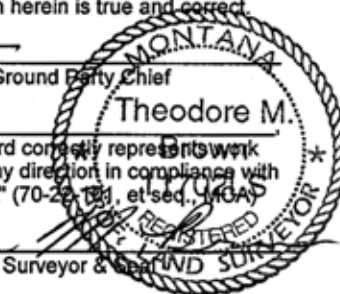

Office of Clerk and Recorder, County of LIBERTY. This "corner record" was filed for record on December 11, 2002 @ 12:30PM was noted on the cross-index plat, and is assigned Page No. \_\_\_\_\_, in Book No. \_\_\_\_\_

*[Signature]*  
County Official

Sec. 20

			●

● — Corner this sheet

Cross Index No. P-9 T. 32N., R. 6E., PMM