

INSTRUCTIONS

1. Original and/or subsequent record used to evaluate the corner position.
2. Description of evidence found, note discrepancies in the record, state method of establishing lost or obliterated corners.
3. Description of monument and accessories set to perpetuate the corner position.
4. Sketch of corner, show all pertinent data which can best be shown in a sketch example, corner marking, topography ties, position of accessories, etc.
5. Certification must be signed and sealed by Land Surveyor registered in the State of Montana.
6. Fill in Cross Index & Section Diagram at bottom of sheet.

CERTIFIED CORNER RECORDATION

Corner # 2 HES 417, ^{1/4} S24 S19 T32N R. 33W P.M.M. Lincoln County

I. 1903 GLO Record: Set a limestone, 16x8x4in., 11ins. in the ground, for 1/4 sec. cor., marked 1/4 on W. face;

from which:

- A fir, 6in. diam., bears N.69°E., 9 lks. dist., marked 1/4 S 19 BT.
- A pine, 7in. diam., bears N.71°W., 20 lks. dist., marked 1/4 S 24 BT.

Cor.#2 Hes 417 June 21, 1915, USDA Record: Cor. #2 identical with point for cor. #4 of the listing survey, and identical with the 1/4 cor. of secs. 19 and 24, heretofore described. Set a stake alongside marked 2 HES 417 on SE face, and a cross(x) on top of 1/4 cor. for the exact corner point.

from which:

- A cross(x) on black pine 10ins. diam., bears S.24°10'W., 25 lks. dist.
 - A cross(x) on a black pine 15ins. diam., bears S.34°35'W., 55 lks. dist.,
- each blazed and scribed 2HES 417 BT. Raise a mound of earth 4 ft. base, 2 ft. high, SE of corner.

1968 BLM Remonumentation: Set an iron post, 30ins. long, 2 1/2 in. diam., 20ins. in the ground, and in a mound of stone, 3 ft. base, to top, with brass cap mkd.

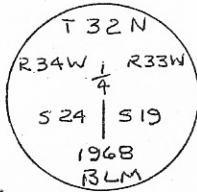

from which the original bearing trees:

- A stump hole, bears N.71°W., 20 lks. dist., with a fallen log mkd. 1/4 S24 BT. (Record)
- A pine, 15ins. diam., bears S.34°35'E., 55 lks. dist., mkd. 2 HES 417 BT. (Record: S.34°35'W., 55 lks.)

The new bearing trees:

- A pine, 8ins. diam., bears N.69°E., 65 lks. dist., mkd. 1/4 S19 BT.
- A fir, 9ins. diam., bears N.85 1/4°W., 53 lks. dist., mkd. 1/4 S24 BT.

Bury the original stone alongside the iron post.

(OVER)

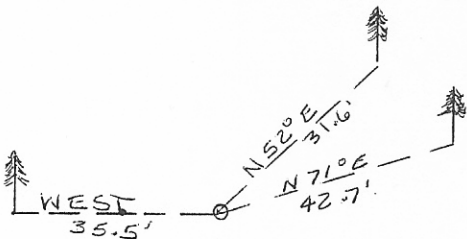

SKETCH OF CORNER

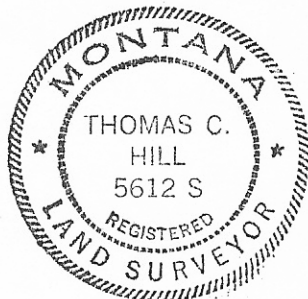

CERTIFICATION

I, Ronald Pearson
 certify the information shown herein is true and correct.
Ronald Pearson
 Signature Ground Party Chief

I, Thomas C. Hill
 certify that this Corner Record correctly represents work performed by me or under my direction in compliance with the "Corner Recordation Act" (70-22-101, et seq., M.C.A.)
Thomas C. Hill
 Signature of Surveyor & Seal

Date: 6/27/84 Reg. No. 5612S
 Employer: USFS

Office of Clerk and Recorder, County of Lincoln. This "corner record" was filed for record on July 12, 1984 was noted on the cross-index plat and is assigned page No. 2693, in book No. _____

Janet B. Siegel by Jannie Dennis
 County Official Deputy

Sec. 19

• - corner this sheet