

INSTRUCTIONS

1. Original and/or subsequent record used to evaluate the corner position.
2. Description of evidence found, note discrepancies in the record, state method of establishing lost or obliterated corners.
3. Description of monument and accessories set to perpetuate the corner position.
4. Sketch of corner, show all pertinent data which can best be shown in a sketch example, corner marking, topography ties, position of accessories, etc.
5. Certification must be signed and sealed by Land Surveyor registered in the State of Montana.
6. Fill in Cross Index & Section Diagram at bottom of sheet.

CERTIFIED CORNER RECORDATION

Corner 10, 11, 14, 15 T. 35N R. 54E P.M.M. Sheridan County

Record 1904 Set a limestone, 16X8X7 inches, 11 inches in the ground, for the corner of sections 10, 11, 14 and 15, marked with 4 notches on South and 2 notches on East edge; and raise a mound of stone, 2 foot base, 1½ feet high, west of the corner. Pits impracticable.

Found 1991 Limestone rock, 16X8X7 inches, 11 inches in the ground, with 4 notches on the South face and 2 notches on the East face.
 At the corner position I set a 3¼" X 30" aluminum cap and post 28 inches in the ground marked as shown, at the center of the stone. Piled a mound of field stones about the monument.
 Buried the stone alongside the monument.
 Set a 5½ foot steel reference post with MDOH tag, 2 feet north of monument.

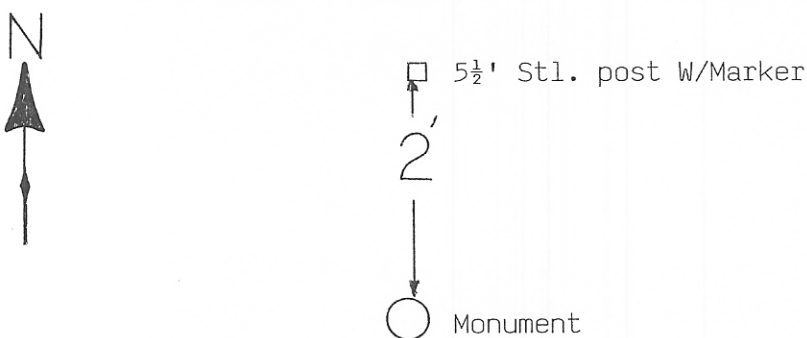
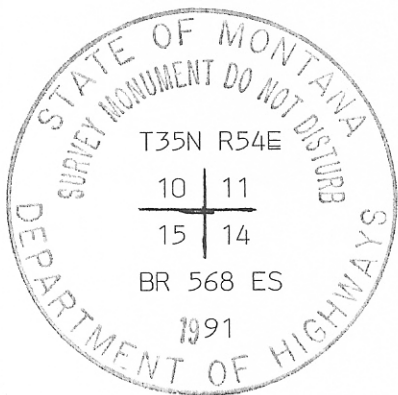

SKETCH OF CORNER

CERTIFICATION

I, Ronald T. Arthur
 certify the information shown herein is true and correct.
Ronald T. Arthur
 Signature Ground Party Chief

I, Bruce Russell
 certify that this Corner Record correctly represents work performed by me or under my direction in compliance with the "Corner Recordation Act" (70-22-101, et seq., M.C.A.)
Bruce Russell
 Signature of Surveyor - Seal

Date: 5-6-91 Reg. No. 568 ES
 Employer: MDOH

Office of Clerk and Recorder, County of Sheridan. This "corner record" was filed for record on May 8, 1991 was noted on the cross-index plat and is assigned page No. _____, in book No. #155

433194

Milton E. Goulard
 County Official
By Denise Van Curen Deputy

Cross Index No. 4-17 T. 35N R. 54E P.M.M.

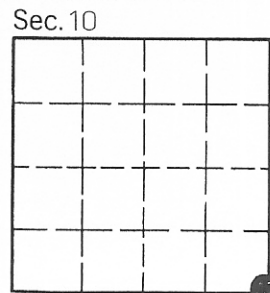

• - corner this sheet